

- LEGEND**
- X DENOTES TREE TO BE REMOVED \* (IF NOT DENOTED, TREE TO REMAIN)
  - [Dotted Pattern] DENOTES PROPOSED PAVEMENT
  - [Cross-hatch Pattern] DENOTES PROPOSED DEMOLITION OF PAVEMENT
  - [Diagonal Line Pattern] DENOTES PROPOSED MILL AND OVERLAY
  - [Triangle with X] DENOTES EXIST. PIPE AND INLET TO BE REMOVED
  - [Triangle with V] VDOT STD. CG-6 REQ'D.
  - [Triangle with M] VDOT STD. MC-3 REQ'D.
  - [Triangle with A] DENOTES EXIST. PIPE AND INLET TO BE ABANDONED

\* The County will update the Tree Inventory and Preservation Plans.

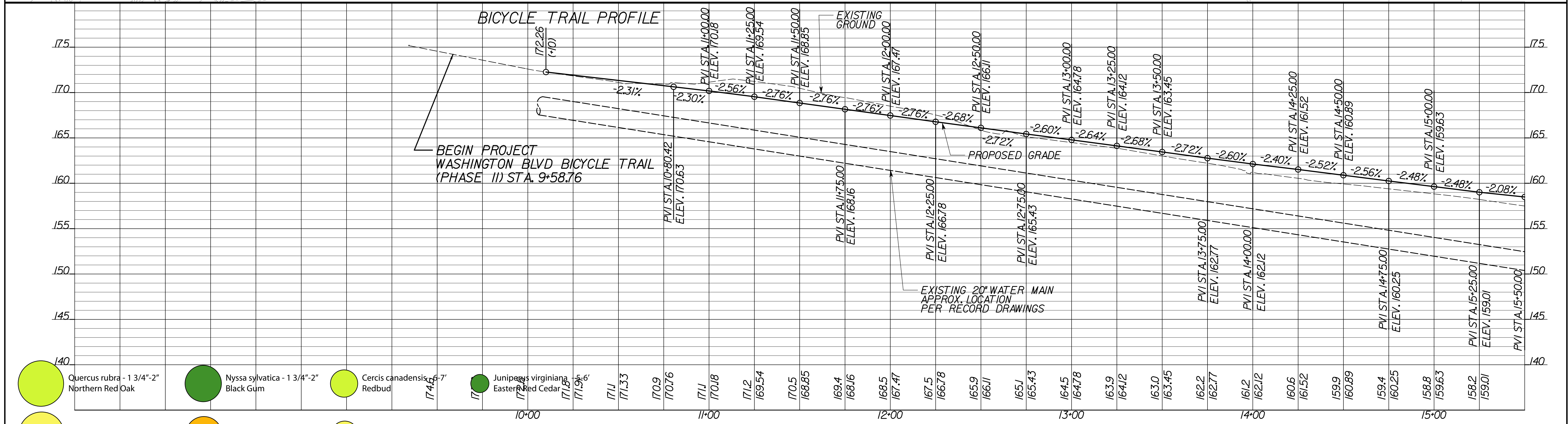

- Quercus rubra - 1 3/4"-2" Northern Red Oak
- Quercus palustris - 2"-2 1/2" Pin Oak
- Cercis canadensis - 6-7' Redbud
- Salix nigra - 1 3/4"-2" Black Willow
- Platanus occidentalis - 2"-2 1/2" American sycamore
- Nyssa sylvatica - 1 3/4"-2" Black Gum
- Quercus falcata - 3-4' Southern Red Oak
- Ostrya virginiana - 6-7' Eastern Hophornbeam
- Robinia pseudoacacia - 3-4' Black Locust
- Diospyros virginiana - 3-4' Persimmon
- Chionanthus virginicus - 6-7' White Fringetree
- Hold - 3-4' 15' tree
- Juniperus virginiana - 5-6' Eastern Red Cedar
- Pinus virginiana - 5-6' Virginia Pine
- Thuja occidentalis - 3-4' Arborvitae
- Ilex opaca female - 5-6' American holly

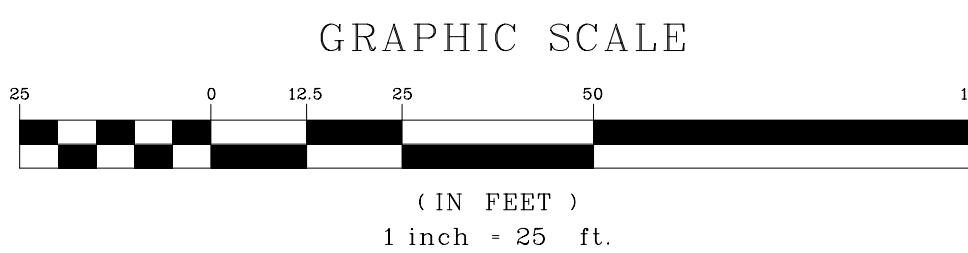

REV	DATE	DESCRIPTION

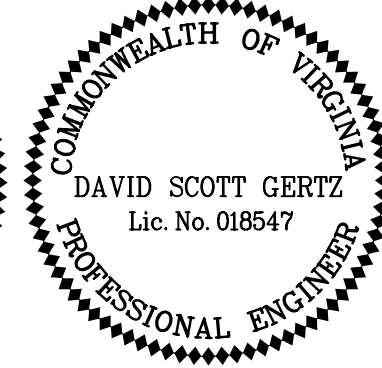
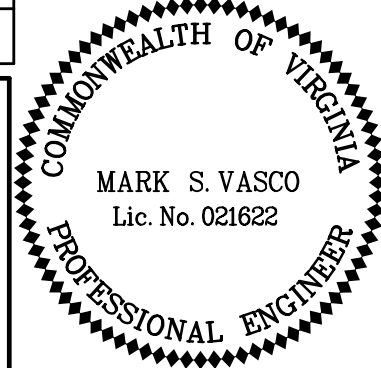

ARLINGTON COUNTY DEPARTMENT OF ENVIRONMENTAL SERVICES			
WASHINGTON BOULEVARD (ROUTE 27) BICYCLE TRAIL - PHASE II PLAN & PROFILE			
SCALE: HORIZ = 1"=25' VERT. = 1"=5'	DESIGNED	CHECKED	
SUBMITTED DATE	APPROVED DATE	APPROVED DATE	
APPROVED DATE	CHEF TRANSPORTATION PLANNING BUREAU	APPROVED DATE	
APPROVED DATE	CHEF ENGINEERING BUREAU	APPROVED DATE	
CHEF WATER, SEWER & STREETS BUREAU	CHEF ENGINEERING BUREAU	DIRECTOR OF ENVIRONMENTAL SERVICES	
APPROVED DATE	CHEF ENGINEERING BUREAU	SHEET	CONTRACT NO.
CHEF COMMUNITY IMPROVEMENT DIVISION, CPD		<b>C-3</b>	