



PMIT Project

Monday, August 22, 2022

The Property Maintenance & Improvements Team of
Walker Chapel United Methodist Church

BACKGROUND

The cemetery has long wanted a place to store landscaping and gravestone repair tools and supplies in the cemetery. Currently all such items are stored in an office in the basement of the Chapel administrative building and it is a real struggle to carry them to the cemetery when needed.

Our need has been heard and answered ... a small shed has been donated to the cemetery. The shed is only 4' x 8' and the side eaves are about 4 1/2 feet tall. Show here in the donor's home.

Arlington County Permits has told us no permit is needed given the small size of the shed. Arlington County Zoning has told us no zoning permit is require as long as it is set the required distance from the property line.



PLACEMENT

A location has been selected at the rear of the cemetery that is hidden from view from the main cemetery by 30' tall decades old box woods and trees. It is convenient to the rear entrance to the cemetery used by heavy equipment bringing in concrete vaults, backhoes, and trucks. It is at a high point in elevation so that all parts of the cemetery grounds are down-hill from the shed. Below is a Photoshop rendition of the shed in place.

We have three 6' tall boxwoods that must be moved due to the approved replacement of the retaining wall around the cemetery, now in progress. We would like to replant the three boxwoods rather than throw them away. The proposal is to plant two of the boxwoods to the left side of the shed and one to the right.. This way the shed would be hidden by natural vegetation from the left, right, and front. It is hidden from the back by a 6' tall wooden fence installed by the homeowner on the other side of the fence.

We believe the placement of the shed is subject to the review and approval of the Historic Affairs Landmark Review Board and request a CoA.





PMIT Project

Monday, August 22, 2022

The Property Maintenance & Improvements Team of Walker Chapel United Methodist Church

View from the Cemetery

This is the view from the main cemetery. The back fence is barely visible between the large boxwoods and trees.



Survey Documentation

The complete grounds of Walker Chapel were recently surveyed and that document is included as an attachment. The proposed location of the shed is shown below on a close-up of the survey.

The general area contains rows of gravesites and that information is shown below from left side row 15 to the last row, row 20. A graphic by grave status is attached that indicates gravesites from available to occupied. Finally, a closeup of the area of the shed is shown using the survey document superimposed with rows 15-20.

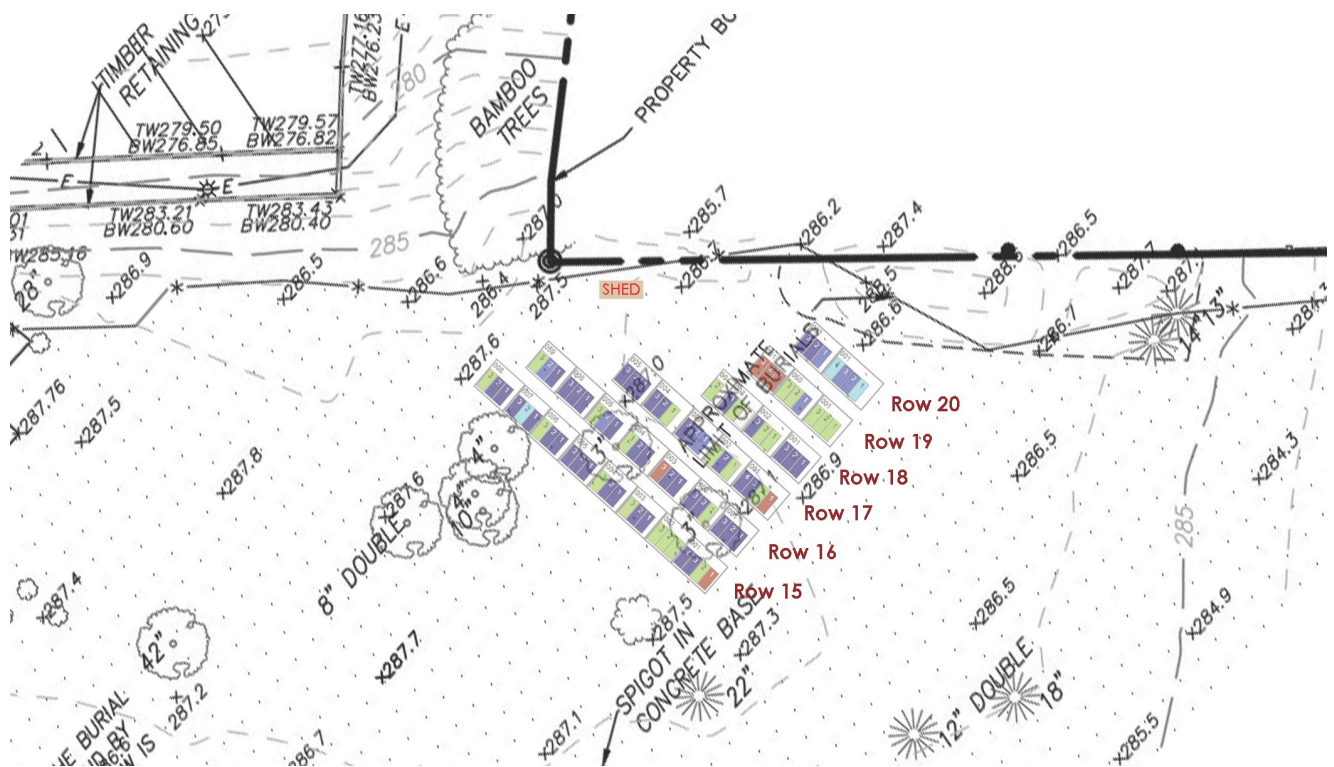



PMIT Project

Monday, August 22, 2022

The Property Maintenance & Improvements Team of Walker Chapel United Methodist Church

View from the Neighbor

There is a home on the other side of the fence at the back of the cemetery. The fence was erected by the homeowner.

The ground falls away quickly from the fence to the home. When standing at the base of the hill, the top of the shed will not be visible.

The shed and the home are similar in style and color.



Gravesites

The layout of the cemetery is shown below. The area of the shed is shown enlarged rows L15 to L20.

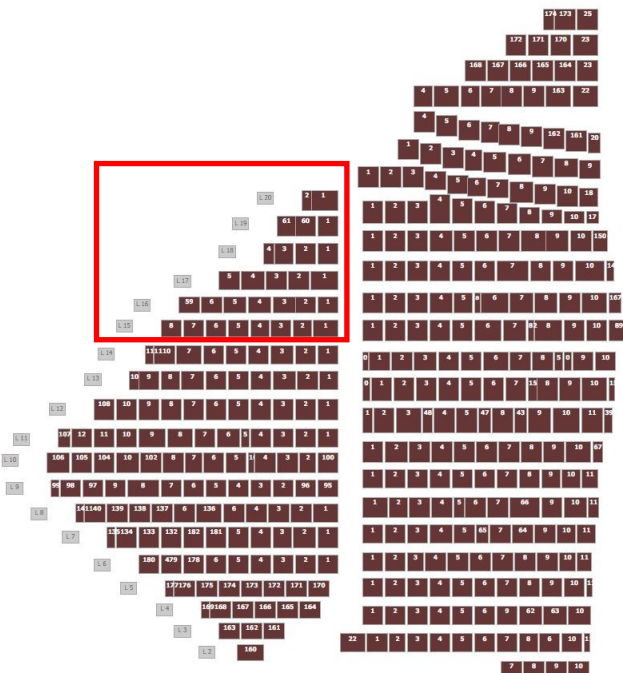

Gravesite Information

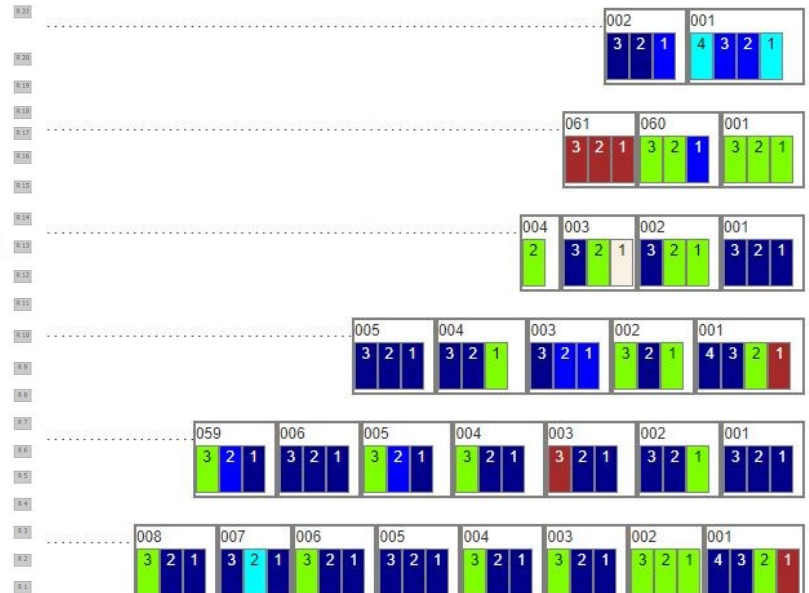

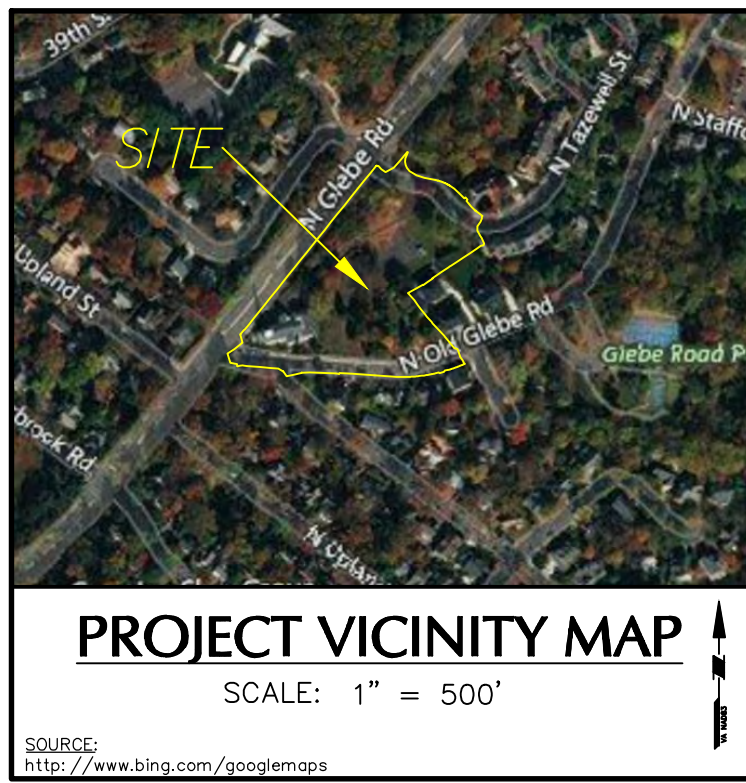

LEGEND (NOT SHOWN TO SCALE)	
	AIR CONDITIONING UNIT
	BOLLARD
	COLUMN
	DOOR
	DOUBLE DOOR
	VENT
	SIGN
	SHRUB
	TREE
	GROUND LIGHT
	CABLE BOX HAND HOLE
	CATCH BASIN
	CLEANOUT
	ELECTRIC BOX
	ELECTRIC METER
	FIRE HYDRANT
	GAS METER
	GAS VALVE
	GUY WIRE
	LIGHT POLE
	MANHOLE (TYPE AS LABELED)
	POWER POLE
	ROOF DRAIN
	LIGHT POLE
	BENCH
	TRAFFIC BOX
	WATER METER
	WATER VALVE
	SPOT ELEVATION
	IRON PIPE FOUND
	PK NAIL FOUND
	MONUMENT FOUND
	CONCRETE PAD
	LANDSCAPED AREA
	TOP OF WALL
	BOTTOM OF WALL
	TOP OF CURB
	BOTTOM OF CURB
	STOCKADE FENCE
	CHAINLINK FENCE
	TREE LINE
	OVERHEAD WIRE
	EASEMENT LINE
	PROPERTY LINE
	RIGHT-OF-WAY LINE
	CONTOUR LINE
	DRAINAGE MARK OUT LINE
	ELECTRIC MARK OUT LINE
	COMMUNICATION MARK OUT LINE
	GAS MARK OUT LINE
	SANITARY SEWER MARK OUT LINE
	WATER MARK OUT LINE
	UNKNOWN MARK OUT LINE
	REFERENCE UTILITY LINE (TYPE AS NOTED) - PLOTTED FROM EXISTING MAPPING
	CEMETERY AREA

- NOTES:**
1. THE MERIDIAN OF THIS SURVEY IS REFERENCED TO THE VIRGINIA STATE PLANE COORDINATE SYSTEM NAD 83.
 2. ELEVATIONS SHOWN ARE REFERENCED TO THE NORTH AMERICAN VERTICAL DATUM (NAVD 88)
 3. PLANIMETRIC INFORMATION SHOWN HEREON HAS BEEN OBTAINED FROM GROUND SURVEYS BY LANGAN ENGINEERING AND ENVIRONMENTAL SERVICES, INC. DURING JUNE 2019.
 4. OFFSETS (IF SHOWN) ARE FOR SURVEY REFERENCES ONLY AND SHOULD NOT BE USED IN CONSTRUCTION OF ANY TYPE. LANGAN ENGINEERING AND ENVIRONMENTAL SERVICES, INC. RECOMMENDS THE PLACEMENT OF SURVEY MARKERS.
 5. WETLANDS, ENVIRONMENTAL AND/OR HAZARDOUS MATERIALS LOCATION, IF ANY, NOT COVERED UNDER THIS CONTRACT.
 6. UNLESS SPECIFICALLY NOTED HEREON, STORM AND SANITARY SEWER INFORMATION (INCLUDING PIPE INVERT, PIPE MATERIAL, AND PIPE SIZE) WAS OBSERVED AND MEASURED AT FIELD LOCATED STRUCTURES (MANHOLES/CATCH BASINS, ETC.). CONDITIONS CAN VARY FROM THOSE ENCOUNTERED AT THE TIMES WHEN AND THE LOCATIONS WHERE DATA WAS OBTAINED. DESPITE MEETING THE REQUIRED STANDARD OF CARE THE SURVEYOR CANNOT AND DOES NOT WARRANT THAT PIPE MATERIAL AND/OR PIPE SIZE THROUGHOUT THE PIPE RUN ARE THE SAME AS THOSE OBSERVED AT EACH STRUCTURE, OR THAT THE PIPE RUN IS STRAIGHT BETWEEN THE LOCATED STRUCTURES. ADDITIONAL UTILITY (WATER, GAS, ELECTRIC ETC.) DATA SHOWN FROM FIELD LOCATED EXISTING STRUCTURES, AND/OR FROM EXISTING DRAWINGS, UNLESS SPECIFICALLY NOTED HEREON THE SURVEYOR HAS NOT EXCAVATED TO PHYSICALLY LOCATE THE UNDERGROUND UTILITIES. THE SURVEYOR MAKES NO GUARANTEES THAT THE SHOWN UNDERGROUND UTILITIES ARE EITHER IN SERVICE, ABANDONED OR SUITABLE FOR USE, NOR ARE IN THE EXACT LOCATION OR CONFIGURATION INDICATED HEREON.
 7. PRIOR TO ANY DESIGN OR CONSTRUCTION THE PROPER UTILITY AGENCIES MUST BE CONTACTED FOR VERIFICATION OF UTILITY TYPE AND FOR FIELD LOCATIONS.
 8. ALL CURBS IN THE SITE ARE CONCRETE.

REVISIONS		
Date	Description	No.

LANGAN
 Langan Engineering and Environmental Services, Inc.
 1300 Wilson Boulevard, Suite 450
 Arlington, VA 22209

T: 571.366.6800 F: 571.366.6801 www.langan.com

WALKER CHAPEL METHODIST CHURCH
 #4102 NORTH GLEBE ROAD

ARLINGTON COUNTY VIRGINIA

PARTIAL TOPOGRAPHIC SURVEY PLAN

Project No. 270082201	Drawing No. VT101
Date 04/24/2020	Sheet 3 of 19
Drawn By KDC	
Checked By CMC	

