

# Historical Affairs and Landmark Review Board

Arlington County, Virginia



**HALRB Meeting January 17, 2024, CoA 19-27C**

**4102 N. Glebe Rd.:** Request to amend CoA 19-27A for site electrical work and screening.



**THIS AREA IS THE LOCATION OF THE SITE ELECTRICAL INFRASTRUCTURE HUB. IT PROVIDES POWER, METERING, AND CONTROLS FOR NEW RETAINING WALL LIGHTING, NEW CEMETERY STEP LIGHTING, NEW PARKING LOT LIGHTING, AND SITE CONVENIENCE POWER OUTLETS**

**RETROACTIVE CoA REQUEST AREA APPROX. 75 SF**

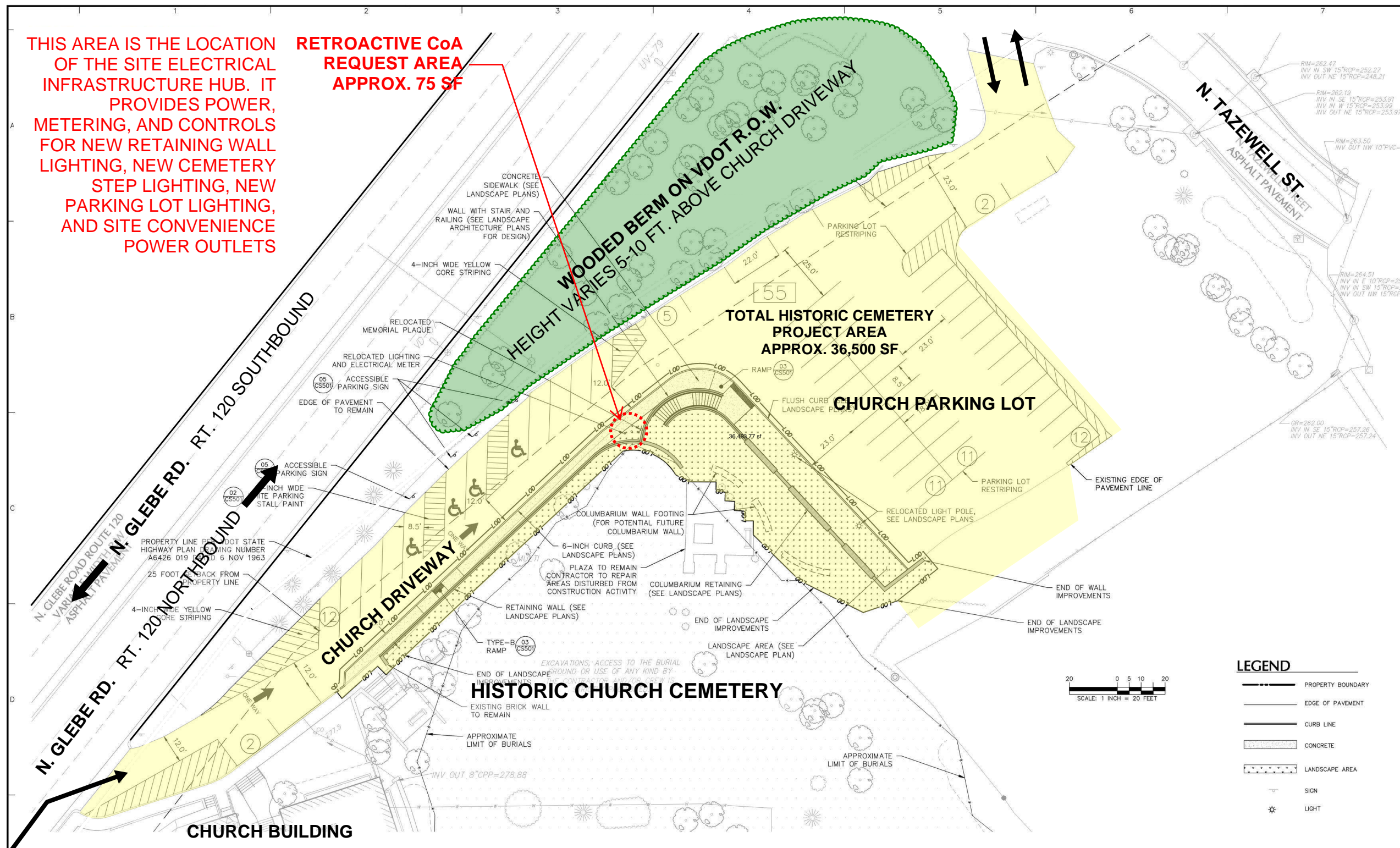

PROPERTY LINE IS FROM VDOT STATE HIGHWAY PLAN (1.736 MI. E. INT. N. UPLAND STREET TO 0.034 MR. E. INT. N. UPLAND STREET) DRAWING NUMBER A6426 019 DATED 6 NOV 1963. PROPERTY LINE TO BE VERIFIED IN FIELD BEFORE CONSTRUCTION.

PARKING SUMMARY	
NUMBER OF EXISTING PARKING SPOTS	55
NUMBER OF REQUIRED SPOTS	49
NUMBER OF PROPOSED PARKING SPOTS (WITHIN PROPERTY BOUNDARY)	50
NUMBER OF PROPOSED PARKING SPOTS (TOTAL)	55

**LEGEND**

- PROPERTY BOUNDARY
- EDGE OF PAVEMENT
- CURB LINE
- CONCRETE
- LANDSCAPE AREA
- SIGN
- LIGHT

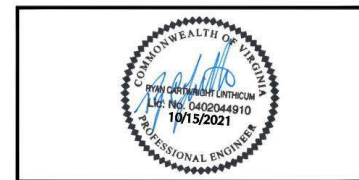

REVISIONS		
Date	Description	No.
05/09/2022	VDOT PROPERTY LINE REVISION	01

**LANGAN**  
Langan Engineering and Environmental Services, Inc.  
1300 Wilson Boulevard, Suite 450  
Arlington, VA 22209  
T: 571.366.6800 F: 571.366.6801 www.langan.com

Project  
**WALKER CHAPEL METHODIST CHURCH**  
ARLINGTON COUNTY VIRGINIA

Drawing Title  
**SITE PLAN**

Project No. <b>270082201</b>	Drawing No. <b>CS101</b>
Date <b>04/14/2022</b>	
Drawn By <b>KDC</b>	
Checked By <b>LKP</b>	



**VIEW OF PROJECT AREA FROM ATOP THE N. GLEBE RD. VDOT BERM**

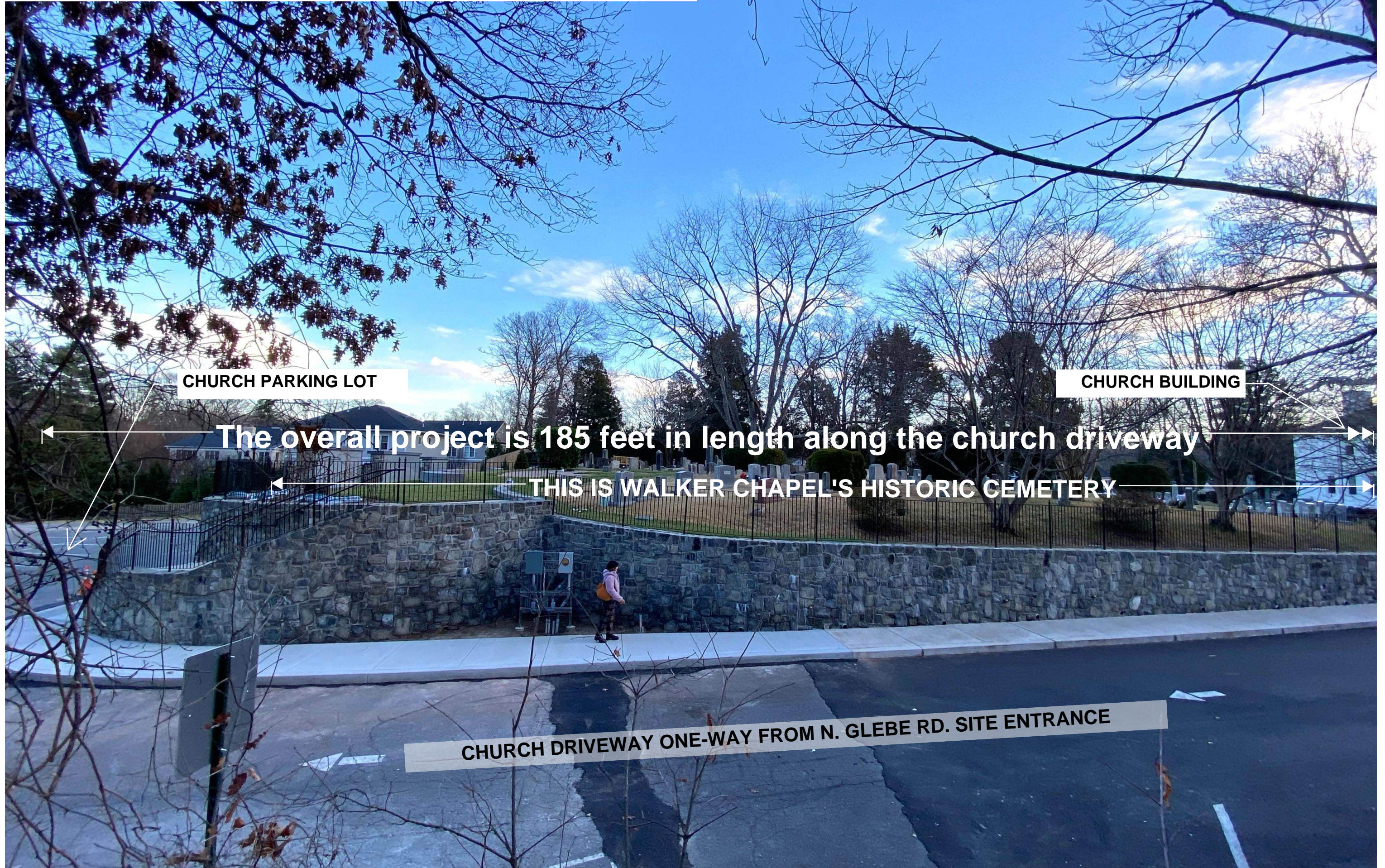

**CHURCH PARKING LOT**

**CHURCH BUILDING**

**The overall project is 185 feet in length along the church driveway**

**THIS IS WALKER CHAPEL'S HISTORIC CEMETERY**

**CHURCH DRIVEWAY ONE-WAY FROM N. GLEBE RD. SITE ENTRANCE**



**VIEW OF PROJECT AREA FROM ATOP THE N. GLEBE RD. VDOT BERM**



**THIS is the route of the underground power feed. The driveway will be re-paved along with the rest of the church parking lot, eliminating awareness of the underground conduits**

**THIS is the area in question-- the site electrical infrastructure hub, 3'-11" wide by 5'-6" high. It is the same 120-amp service as before, but now with code-required commercial-grade equipment**



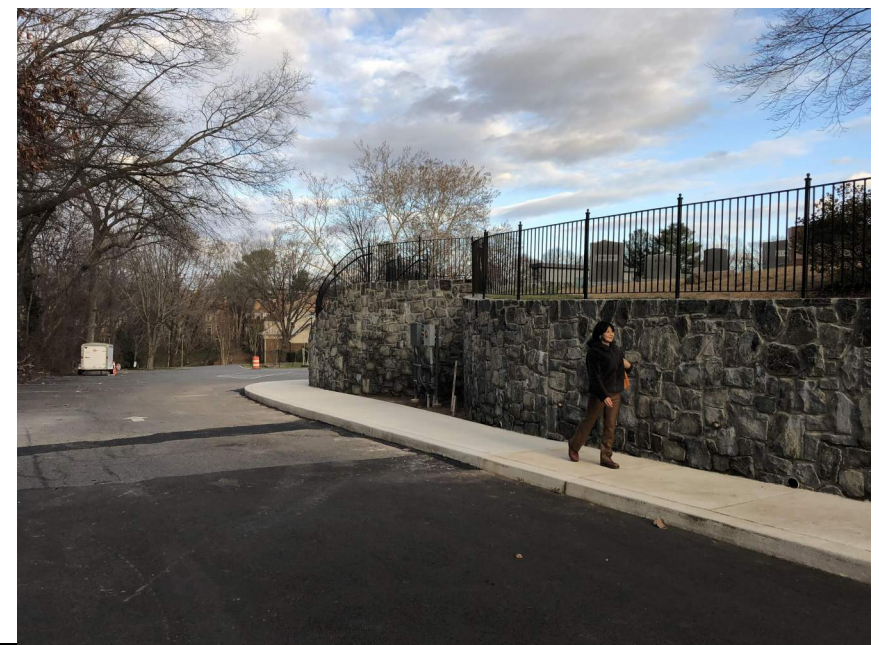

**THIS is the project area in its original state:  
site electrical infrastructure mounted on a  
failing creosote timber retaining wall along the  
church driveway**



**The images above and below show the new  
stone retaining wall and the new driveway  
sidewalk, demonstrating how the site  
electrical hub is not visible until one is  
immediately next to it. Due to the high,  
wooded berm between the church property  
and N. Glebe Rd., there is no off-site visibility  
of the site electrical hub.**

**Due to the site orientation, direct sunlight  
never reaches the fold in the cemetery wall  
where the new site electrical equipment is  
mounted--so it will always be in the shadow of  
the wall.**

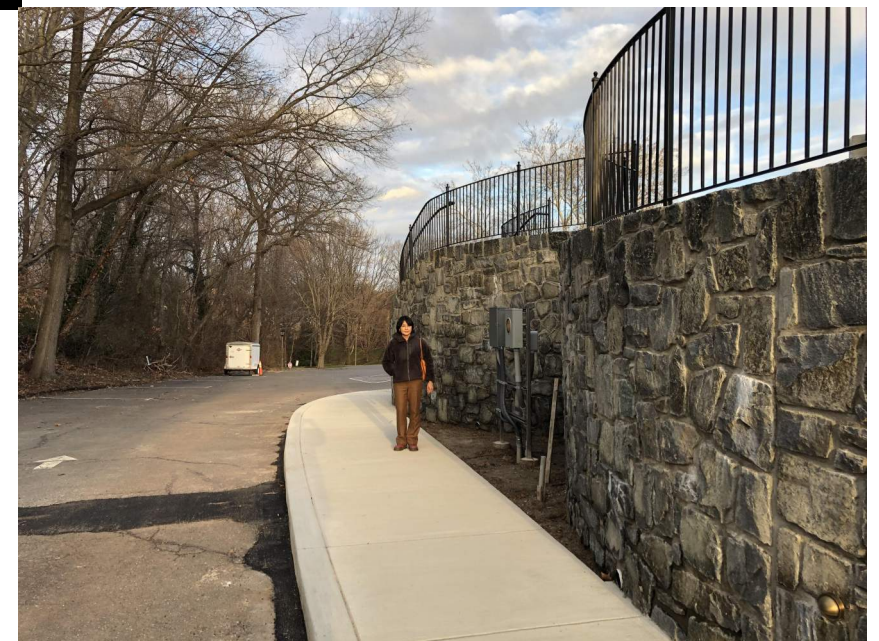
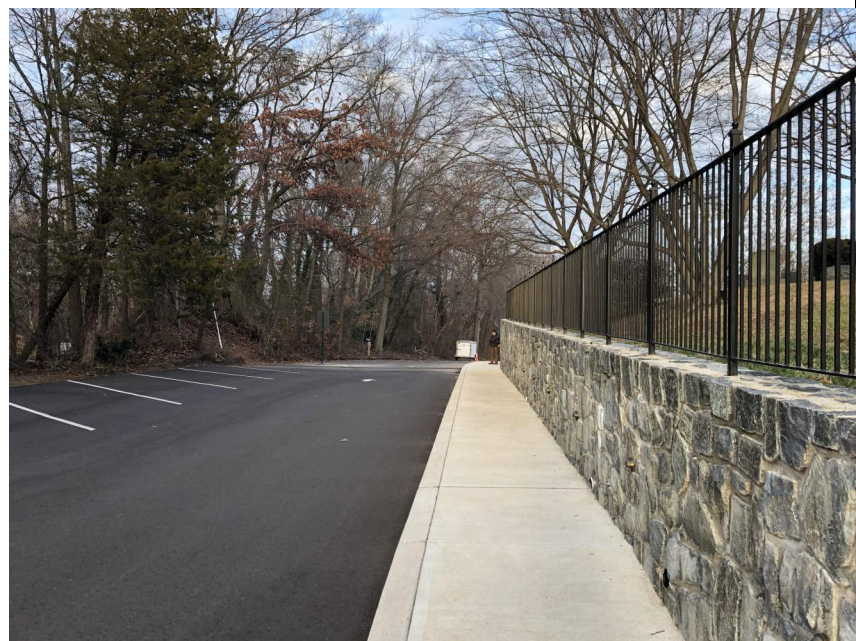



**VIEW OF PROJECT AREA AS PROPOSED IN ITS FINISHED CONDITION**

A mosaic of panel boxes and conduit painted in dark grays as camouflage against the new, natural stone retaining wall

Ajuga (or similar) flowering ground cover to conceal views of the support frame foundations and the in/out electrical conduits

Re-paved driveway and parking lot

