

Arlington Ridge Bridge Replacement

Nate Graham, Public Engagement Specialist
Gabriela Kock, Project Management Coordinator
Vicki Scuri, Project Artist

March 16, 2022



Meeting Agenda

- How this works
- **Project update:** West Glebe Road bridge replacement
 - **Q&A** – W. Glebe Rd bridge
- **Project update:** Arlington Ridge Road bridge replacement
 - **Q&A** – Arlington Ridge Rd bridge
- **Art Enhancements** – Arlington Ridge Road Bridge
 - Engagement Q&A – Art Enhancements for ARR Bridge

How this works:

- This call is being recorded!
- To ask a question, please type into the Chat window
- Use the toolbar to:
 - Open the Chat box > “Chat”
 - Turn on Closed Captions > “Live Transcript”

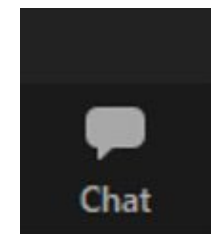
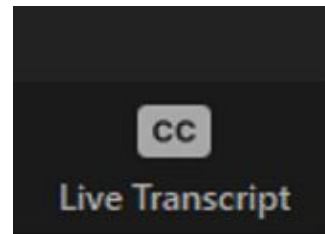
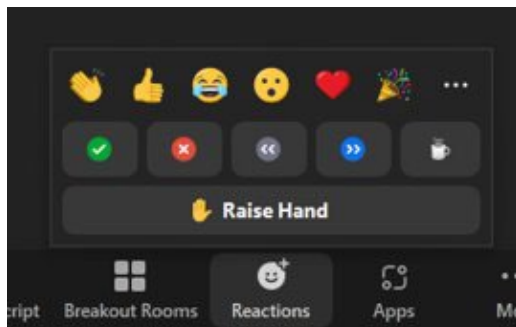

Background

- Both bridges were built in the 1950s and go over Four Mile Run.
- During a routine inspection in 2018 structural deficiencies were detected on West Glebe Road bridge and on Arlington Ridge Road.
- Lane closures and sidewalk closures were implemented to reduce impacts on both bridges.



Arlington Ridge Road



West Glebe Road

Background – West Glebe Road Bridge

- West Glebe Road bridge is experiencing more issues due to flooding and heavy vehicle traffic.
- In April 2018, Arlington County and the City of Alexandria approved a \$10-million-dollar budget to replace the bridge.
- In Winter of 2019, the County and Alexandria hosted public meetings to receive input for the reconstruction of the bridge. Comments were also received via online portal.

Design Update – West Glebe Road Bridge

- Inspired by the public feedback and the Four Mile Run planning documents, staff developed an Ideabook to guide the artist in the design of the new bridge.
- Vicki Scuri Siteworks was selected to complete the artistic elements for West Glebe Road bridge.
- The design of artistic elements has been finalized and construction on West Glebe Road bridge will start in April 2022

Q&A



Arlington Ridge Road Bridge Replacement

- Arlington County and City of Alexandria are partners to replace the bridge deck and improve trail conditions as part of the project.
- The design process is being accelerated due to the structural condition of the bridge.
- The cross section will include wider sidewalks and bike lane in each direction.

Arlington Ridge Road Bridge Replacement

Cross Section for the new Arlington Ridge Road Bridge

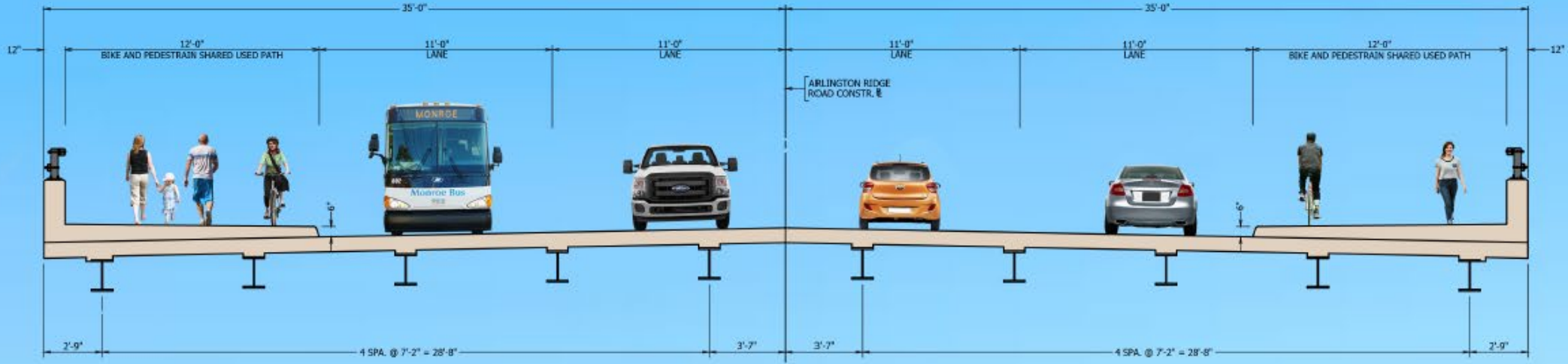

CROSS SECTION VIEW

Arlington Ridge Road Bridge Replacement

- The Four Mile Run Design Guidelines and Master Plan are the guiding documents for the structures replaced and installed within the Four Mile Run area.
- The Design Guidelines speak to the visual flow between bridges and the built environment.
- The County and City of Alexandria selected Vicki Scuri Siteworks to design art enhancements on the bridge.
- We want the public to share their experiences on the bridge with Vicki to generate inspiration for the design.

Q&A



Characteristics of the Master Plan: Guidelines

Design language includes:

- Modern technology and materials
- Complimentary design elements
- Design elements that complement the existing built elements
- Materials of a similar family
- Integration of sustainable elements
- Ease of maintenance



Four Mile Run Restoration Master Plan



Goals – From the West Glebe Ideabook

- Create a signature public art piece for the surrounding community and enhance the safety, comfort and enjoyment of pedestrians, bicyclists, transit riders, and motorists.
- Use light as means to inspire and educate about history and the environment, past, present, and future.
- Be highly visible both day and night.
- Be properly scaled to surroundings.
- Be site-specific illumination to emphasize the bridge.
- Be engaging during all seasons and respect of Dark Sky criteria.



Goals – From the West Glebe Ideabook

- Consider affordability and sustainability: day-to-day operating cost, as well as long-term maintenance.
- Relate to the surrounding environment: bridge elements, natural setting, industrial history, and Army Corps of Engineers stream channelization.
- Incorporate enduring materials able to withstand extreme weather, substantial vehicular, bicycle and pedestrian traffic.
- Appeal to a mass audience.
- Be structurally sound and with minimal maintenance costs.
- Design with the potential to be integrated throughout the Four Mile Run valley.

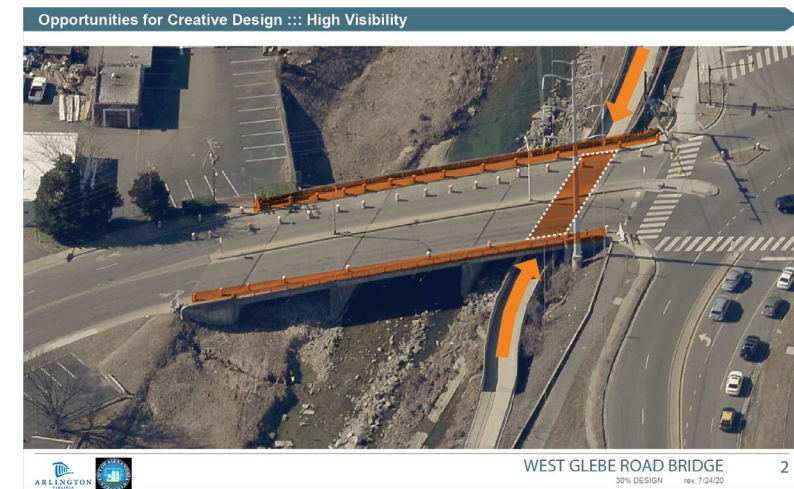

Vicki Scuri SiteWorks – Precedent Projects

Reconnecting Human Nature with Nature



Precedents – Arlington Boulevard



Precedents – Arlington Boulevard



Precedents – Aurora “Bright Dawn”



Precedents – Aurora “Bright Dawn”



Precedents – East Kellogg Webb



Precedents – East Kellogg Webb



Precedents – East Kellogg Greenwich



Precedents – Schantz



Precedents – Schantz



Precedents – Cary Parkway



Precedents – Cary Parkway



Precedents – Cary Parkway



Precedents – West Glebe Road Bridge

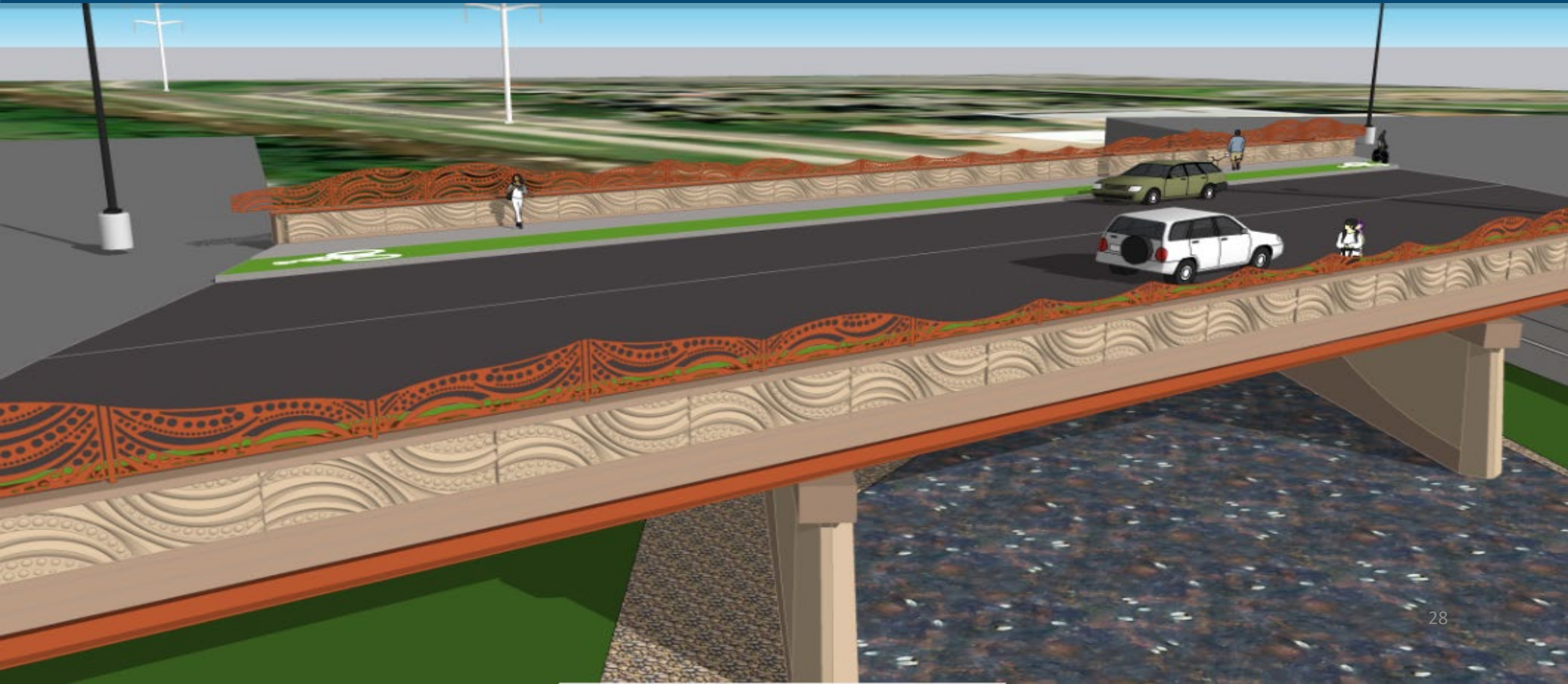

Precedents – West Glebe Road Bridge



Precedents – West Glebe Road Bridge



Precedents – West Glebe Road Bridge

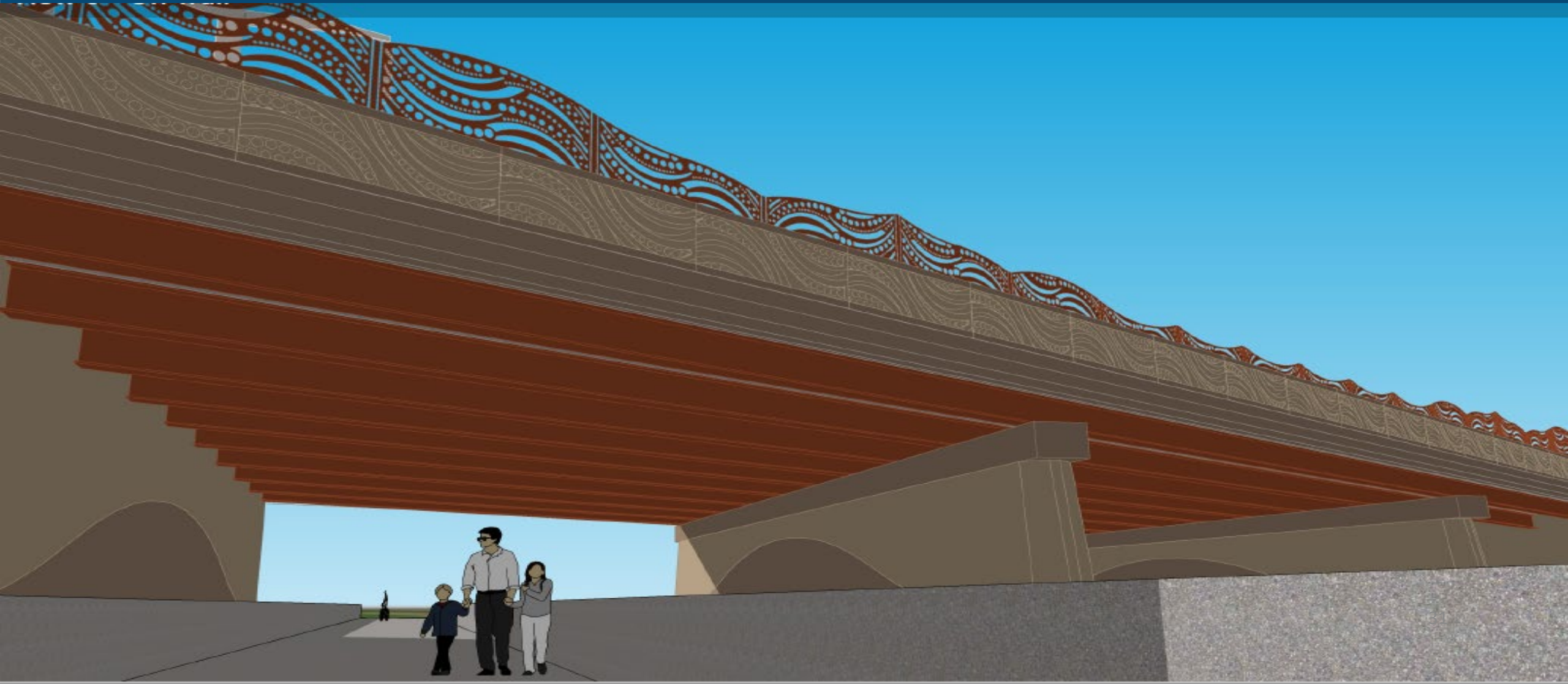

Questions – Arlington Ridge Road Bridge

1) What makes the Four Mile Valley area around the Arlington Ridge Road Bridge special?



2) What natural features, flora and fauna most distinguish the Four Mile Run Valley area?

Questions – Arlington Ridge Road Bridge

3) How do you use the Arlington Ridge Road bridge (driving, cycling, walking, etc.)?



4) Does the bridge and trail need more lighting?

Questions – Arlington Ridge Road Bridge

5) How does your community connect with the bridge and the surrounding area?



6) What colors do you associate with your neighborhood community?

Questions – Suggestions – Aspirations – Goals

