

Realize Rosslyn July Walk-Around
July 18, 2013

A Rosslyn Process Panel event featuring views from building tops

Goals of today's event

- See views into and out of Rosslyn from the tops of several tall buildings.
- **Better understand** existing and potential view corridors - such as those from the planned observation deck at the approved Central Place development.
- **Examine** the pattern of existing building heights and transitions between the center of Rosslyn and surrounding areas.
- **Talk about** some of the draft plan framework elements as we pass by key locations on our walk between buildings.

Walk-around itinerary (times approximate)

- 5:00pm **Assemble in Loading Dock Area of 1812 N. Moore Street**
(located on Fort Myer Drive side of building)
- 5:00-5:30 **Ascend 1812 N. Moore Street for views and discussion**
- 5:30-5:45 **Walk to The Sedona, 1510 Clarendon Boulevard**
- 5:45-6:15 **Ascend The Sedona for views and discussion**
- 6:15-6:30 **Walk to 1100 Wilson Boulevard**
- 6:30-7:00 **Ascend 1100 Wilson Boulevard for views and discussion**
- 7:00 **Adjourn**



1. 1812 North Moore Street (enter from North Fort Myer Drive)
2. 1510 Clarendon Boulevard (Sedona & Slate)
3. 1100 Wilson Boulevard

Reference diagrams from Realize Rosslyn Draft Framework

Diagrams are preliminary and will be updated to reflect community input

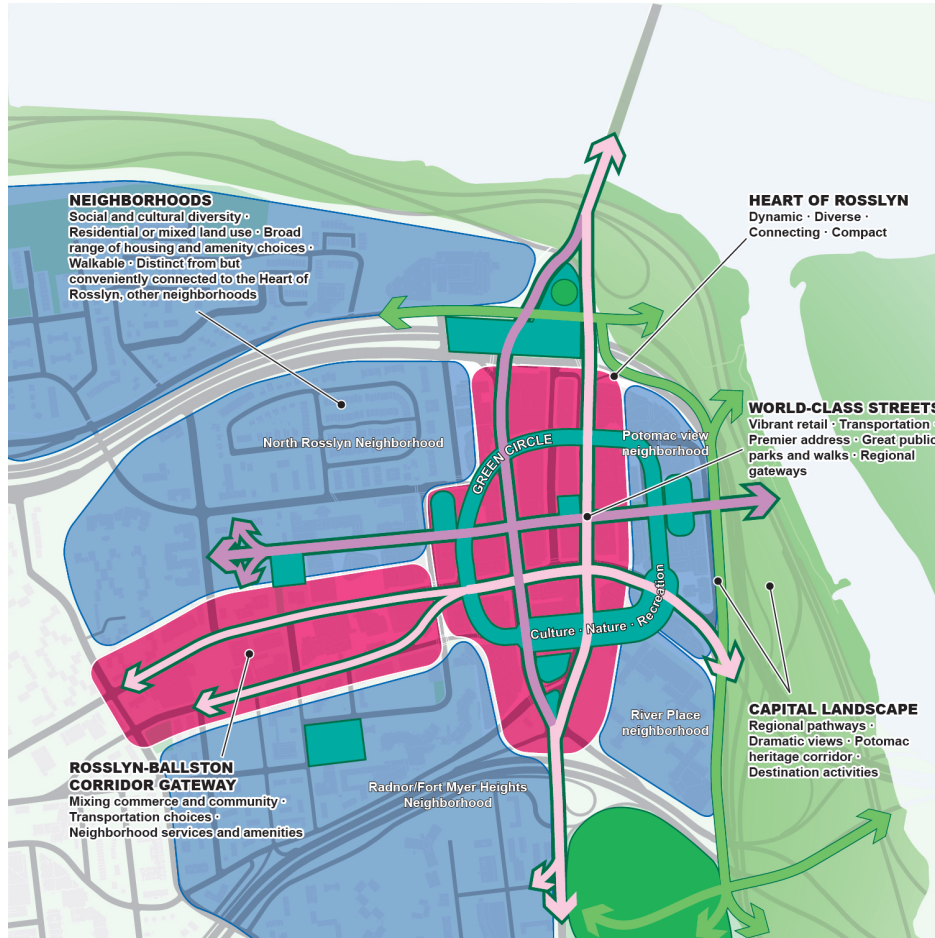

Framework core concept summary



Context edges

Reference diagrams from Realize Rosslyn Draft Framework

Diagrams are preliminary and will be updated to reflect community input



Public observation deck views

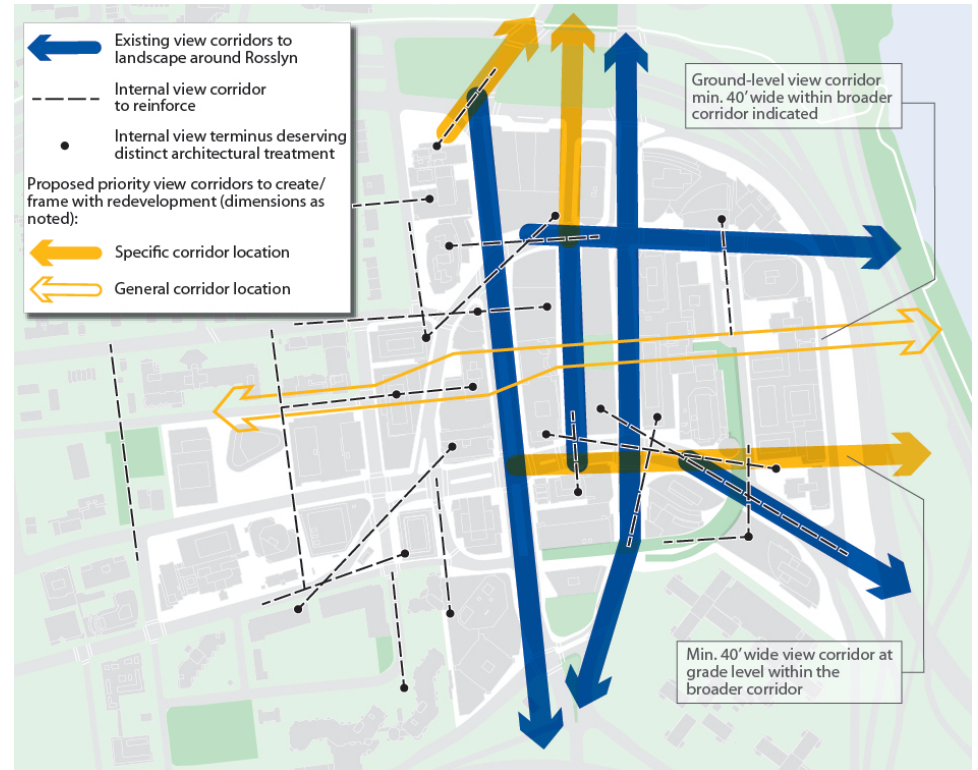

Public views at ground level

Public observation deck at Central Place

- 1 View up Wilson Blvd of Central Place office building with observation deck.
- 2 View from east of approved Central Place project within Rosslyn skyline.
- 3 Plan view of Central Place Plaza observation deck.
- 4 360-degree representation showing views to be had at the elevation of the viewing deck

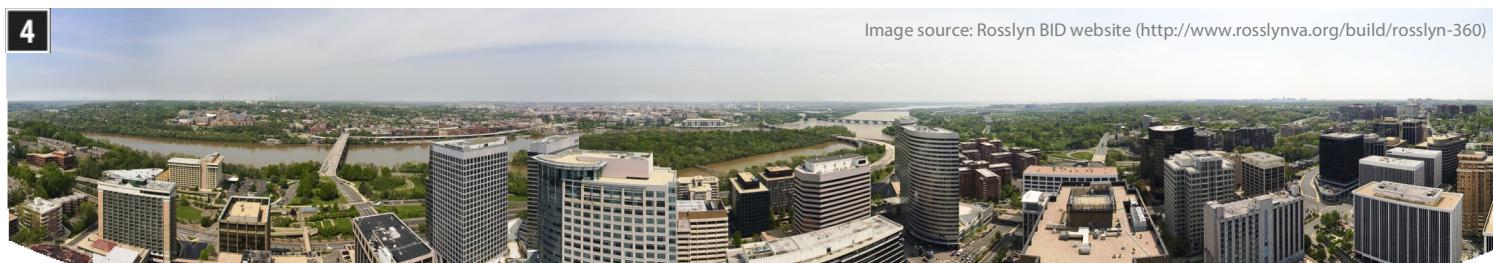
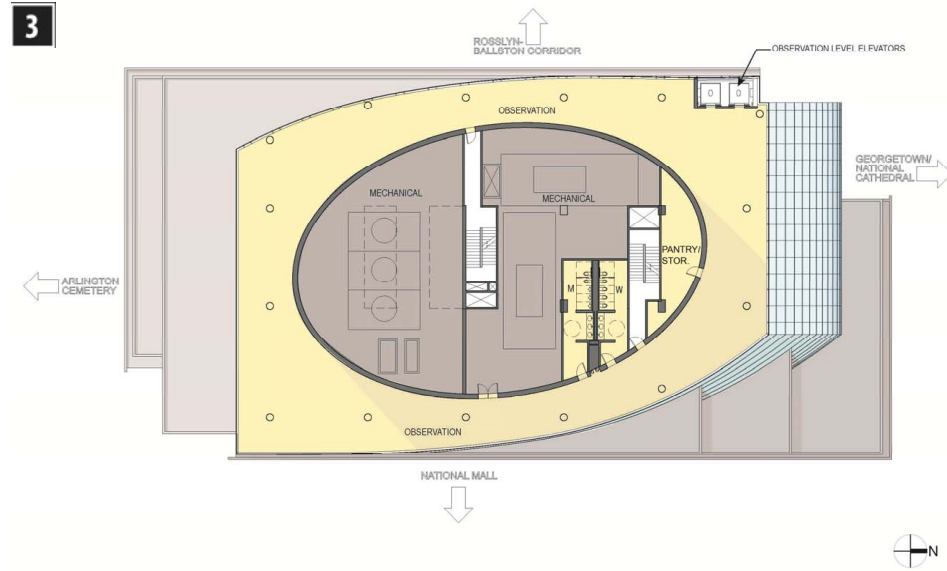

Image source: Rosslyn BID website (<http://www.rosslynva.org/build/rosslyn-360>)