

MATRIX PLANTING A:
 42 EY
 84 PVH
 42 EM

SOUTH OLD GLEBE ROAD

LAWN

MATCHLINE SEE SHEET L3.04.05 - DETAILED PLANTING PLAN #2

MATCHLINE SEE SHEET L3.06.07 - DETAILED PLANTING PLAN #4

VMDO

VMDO Architects
 200 E Market Street
 Charlottesville, VA 22902
 434.296.5684
 vmdo.com

waterstreetstudio
 landscape architecture | civil engineering
 418 E Main Street 434.295.8177 Charlottesville, VA 22902

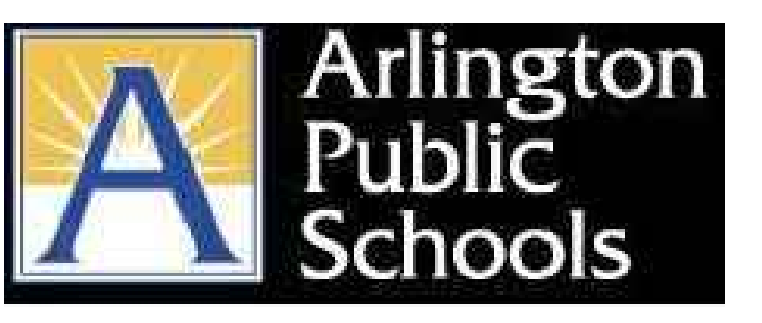

ARLINGTON PUBLIC SCHOOLS

NEW ELEMENTARY SCHOOL

125 South Old Glebe Rd
 Arlington, VA 22204

Client Project Number 60FY16
 VMDO Project Number 1152

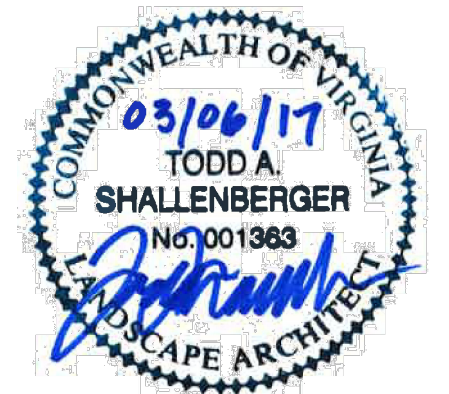

Checked By T. Shallenberger
 Drawn By P. Price

DRAWING NOT FOR CONSTRUCTION

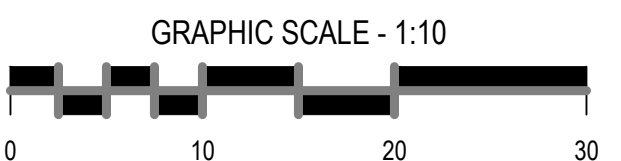

| ISSUES AND REVISIONS | |
|----------------------------|------------|
| NO. | DATE |
| 1. SUBMITTAL | 03.06.2017 |
| 2. USE PERMIT RESUBMISSION | |

DETAILED PLANTING PLAN #1

L3.03

C:\DESIGN\0306\04\05\07\08\09\10\11\12\13\14\15\16\17\18\19\20\21\22\23\24\25\26\27\28\29\30\31\32\33\34\35\36\37\38\39\40\41\42\43\44\45\46\47\48\49\50\51\52\53\54\55\56\57\58\59\60\61\62\63\64\65\66\67\68\69\70\71\72\73\74\75\76\77\78\79\80\81\82\83\84\85\86\87\88\89\90\91\92\93\94\95\96\97\98\99\100\101\102\103\104\105\106\107\108\109\110\111\112\113\114\115\116\117\118\119\120\121\122\123\124\125\126\127\128\129\130\131\132\133\134\135\136\137\138\139\140\141\142\143\144\145\146\147\148\149\150\151\152\153\154\155\156\157\158\159\160\161\162\163\164\165\166\167\168\169\170\171\172\173\174\175\176\177\178\179\180\181\182\183\184\185\186\187\188\189\190\191\192\193\194\195\196\197\198\199\200\201\202\203\204\205\206\207\208\209\210\211\212\213\214\215\216\217\218\219\220\221\222\223\224\225\226\227\228\229\230\231\232\233\234\235\236\237\238\239\240\241\242\243\244\245\246\247\248\249\250\251\252\253\254\255\256\257\258\259\260\261\262\263\264\265\266\267\268\269\270\271\272\273\274\275\276\277\278\279\280\281\282\283\284\285\286\287\288\289\290\291\292\293\294\295\296\297\298\299\300\301\302\303\304\305\306\307\308\309\310\311\312\313\314\315\316\317\318\319\320\321\322\323\324\325\326\327\328\329\330\331\332\333\334\335\336\337\338\339\340\341\342\343\344\345\346\347\348\349\350\351\352\353\354\355\356\357\358\359\360\361\362\363\364\365\366\367\368\369\370\371\372\373\374\375\376\377\378\379\380\381\382\383\384\385\386\387\388\389\390\391\392\393\394\395\396\397\398\399\400\401\402\403\404\405\406\407\408\409\410\411\412\413\414\415\416\417\418\419\420\421\422\423\424\425\426\427\428\429\430\431\432\433\434\435\436\437\438\439\440\441\442\443\444\445\446\447\448\449\450\451\452\453\454\455\456\457\458\459\460\461\462\463\464\465\466\467\468\469\470\471\472\473\474\475\476\477\478\479\480\481\482\483\484\485\486\487\488\489\490\491\492\493\494\495\496\497\498\499\500\501\502\503\504\505\506\507\508\509\510\511\512\513\514\515\516\517\518\519\520\521\522\523\524\525\526\527\528\529\530\531\532\533\534\535\536\537\538\539\540\541\542\543\544\545\546\547\548\549\550\551\552\553\554\555\556\557\558\559\560\561\562\563\564\565\566\567\568\569\570\571\572\573\574\575\576\577\578\579\580\581\582\583\584\585\586\587\588\589\590\591\592\593\594\595\596\597\598\599\600\601\602\603\604\605\606\607\608\609\610\611\612\613\614\615\616\617\618\619\620\621\622\623\624\625\626\627\628\629\630\631\632\633\634\635\636\637\638\639\640\641\642\643\644\645\646\647\648\649\650\651\652\653\654\655\656\657\658\659\660\661\662\663\664\665\666\667\668\669\670\671\672\673\674\675\676\677\678\679\680\681\682\683\684\685\686\687\688\689\690\691\692\693\694\695\696\697\698\699\700\701\702\703\704\705\706\707\708\709\710\711\712\713\714\715\716\717\718\719\720\721\722\723\724\725\726\727\728\729\730\731\732\733\734\735\736\737\738\739\740\741\742\743\744\745\746\747\748\749\750\751\752\753\754\755\756\757\758\759\760\761\762\763\764\765\766\767\768\769\770\771\772\773\774\775\776\777\778\779\780\781\782\783\784\785\786\787\788\789\790\791\792\793\794\795\796\797\798\799\800\801\802\803\804\805\806\807\808\809\810\811\812\813\814\815\816\817\818\819\820\821\822\823\824\825\826\827\828\829\830\831\832\833\834\835\836\837\838\839\840\841\842\843\844\845\846\847\848\849\850\851\852\853\854\855\856\857\858\859\860\861\862\863\864\865\866\867\868\869\870\871\872\873\874\875\876\877\878\879\880\881\882\883\884\885\886\887\888\889\890\891\892\893\894\895\896\897\898\899\900\901\902\903\904\905\906\907\908\909\910\911\912\913\914\915\916\917\918\919\920\921\922\923\924\925\926\927\928\929\930\931\932\933\934\935\936\937\938\939\940\941\942\943\944\945\946\947\948\949\950\951\952\953\954\955\956\957\958\959\960\961\962\963\964\965\966\967\968\969\970\971\972\973\974\975\976\977\978\979\980\981\982\983\984\985\986\987\988\989\990\991\992\993\994\995\996\997\998\999\1000

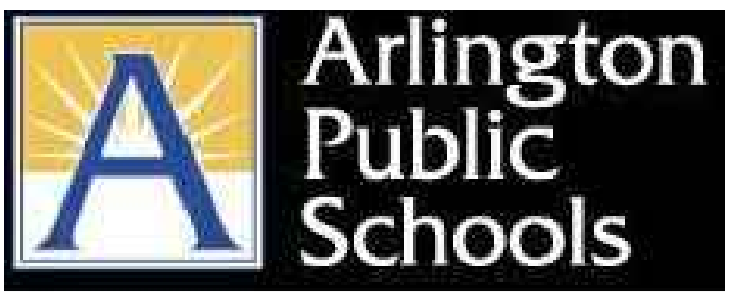

ARLINGTON PUBLIC SCHOOLS

NEW ELEMENTARY SCHOOL

125 South Old Glebe Rd
Arlington, VA 22204

Client Project Number 60FY16
VMDO Project Number 1152

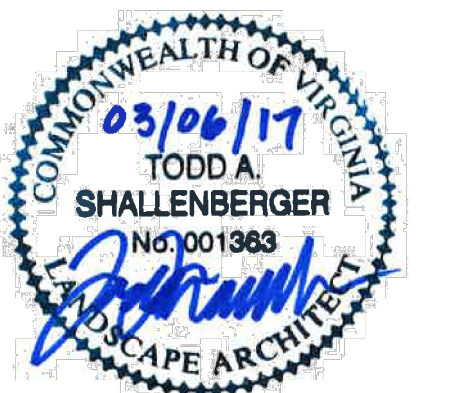

Checked By T. Shallenberger
Drawn By P. Price

DRAWING NOT FOR CONSTRUCTION

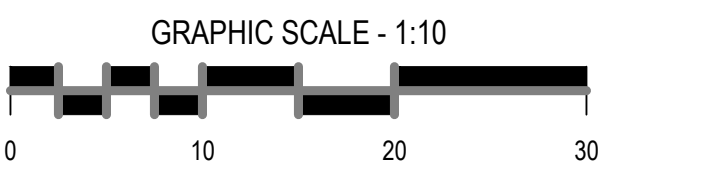

| ISSUES AND REVISIONS | DATE |
|---------------------------------------|------------|
| NO. SUBMITTAL USE PERMIT RESUBMISSION | 03.06.2017 |

DETAILED PLANTING PLAN #2

L3.04

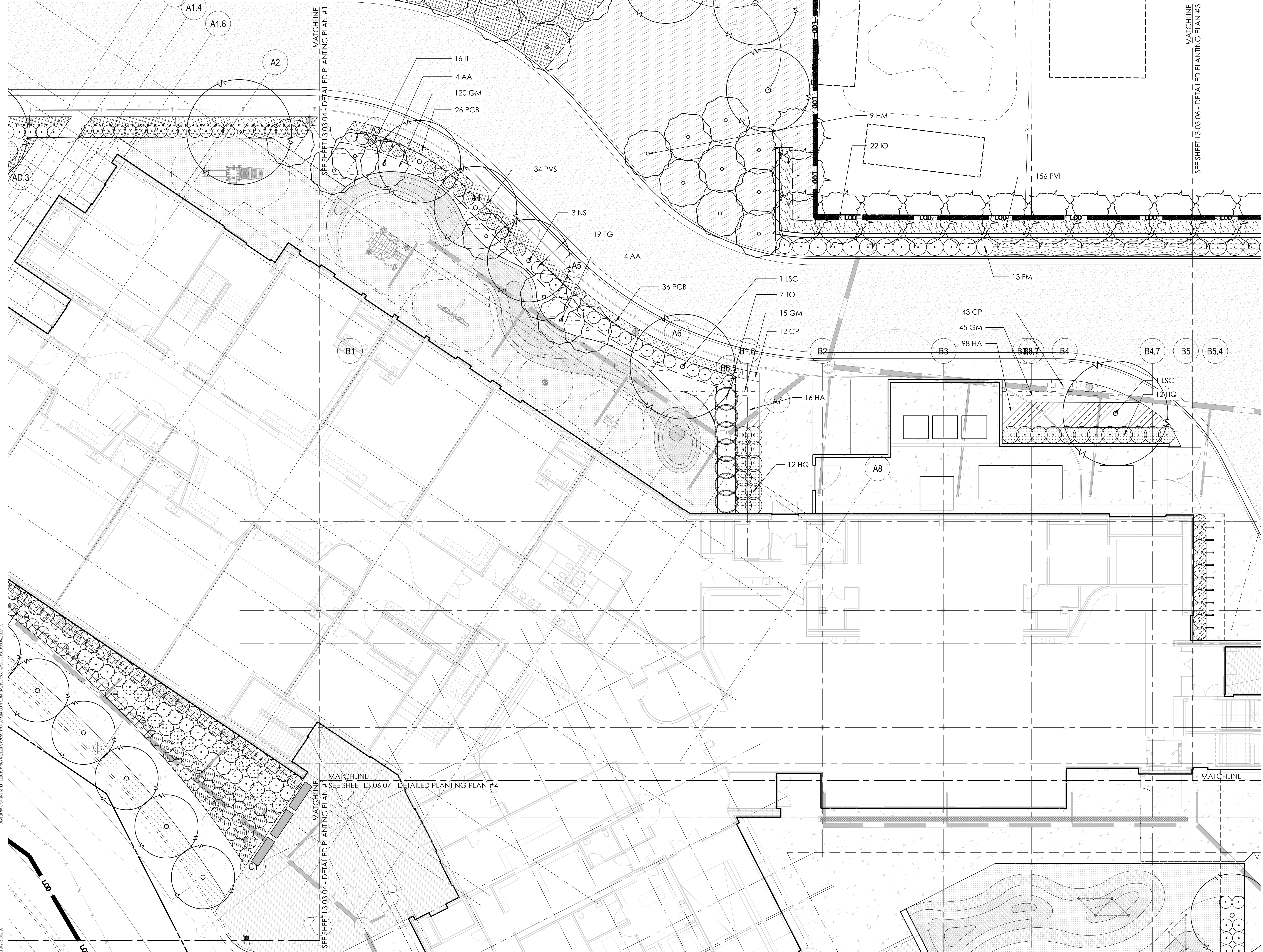

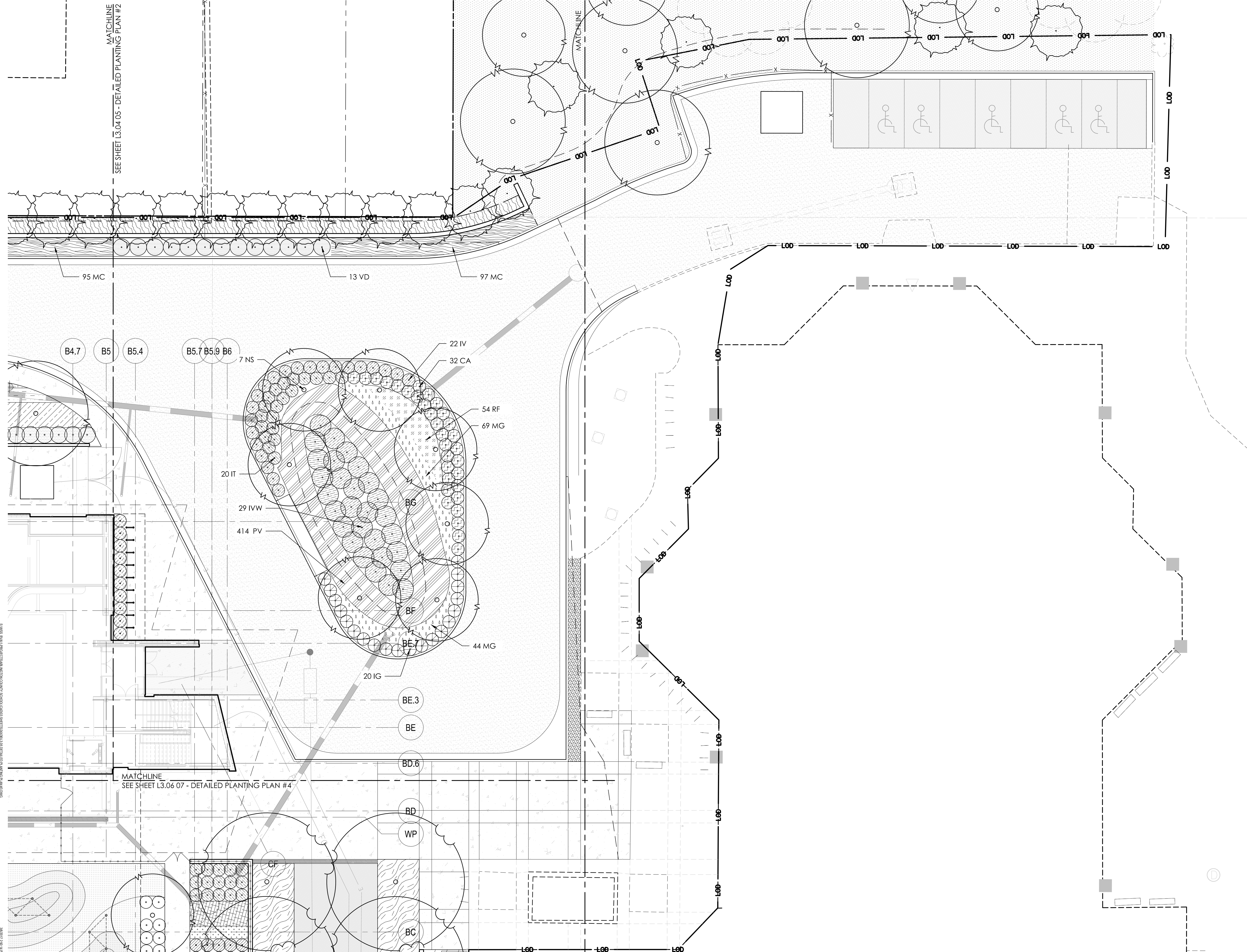

ARLINGTON PUBLIC SCHOOLS

NEW ELEMENTARY SCHOOL

125 South Old Glebe Rd
Arlington, VA 22204

Client Project Number 60FY16
VMDO Project Number 1152

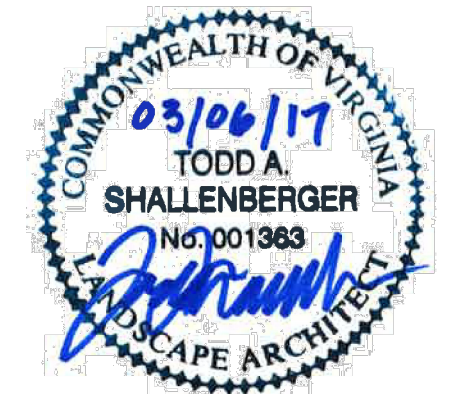

Checked By T. Shallenberger
Drawn By P. Price

DRAWING NOT FOR CONSTRUCTION

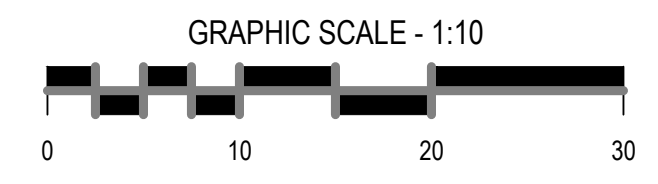

| ISSUES AND REVISIONS | | DATE |
|----------------------|-------------------------|------------|
| NO. | SUBMITTAL | |
| | USE PERMIT RESUBMISSION | 03.06.2017 |

DETAILED PLANTING PLAN #3

L3.05

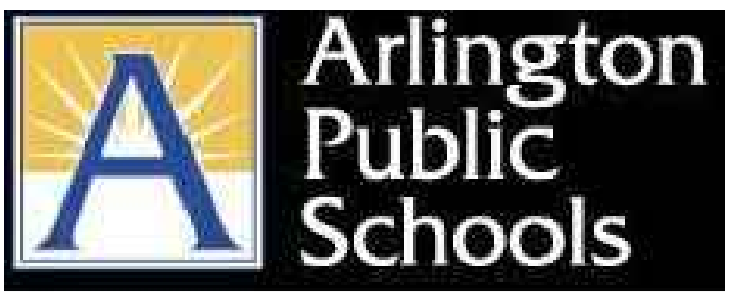

ARLINGTON PUBLIC SCHOOLS

NEW ELEMENTARY SCHOOL

125 South Old Glebe Rd
Arlington, VA 22204

Client Project Number 60FY16
VMDO Project Number 1152

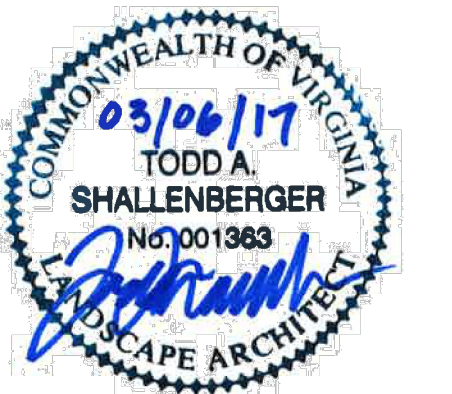

Checked By T. Shallenberger
Drawn By P. Price

DRAWING NOT FOR CONSTRUCTION

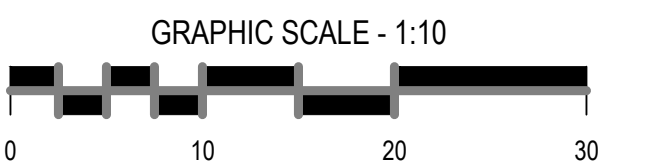

| ISSUES AND REVISIONS | DATE |
|--|------------|
| NO. SUBMITTAL USE PERMIT RESUBMISSION | 03.06.2017 |

DETAILED PLANTING PLAN #4

L3.06

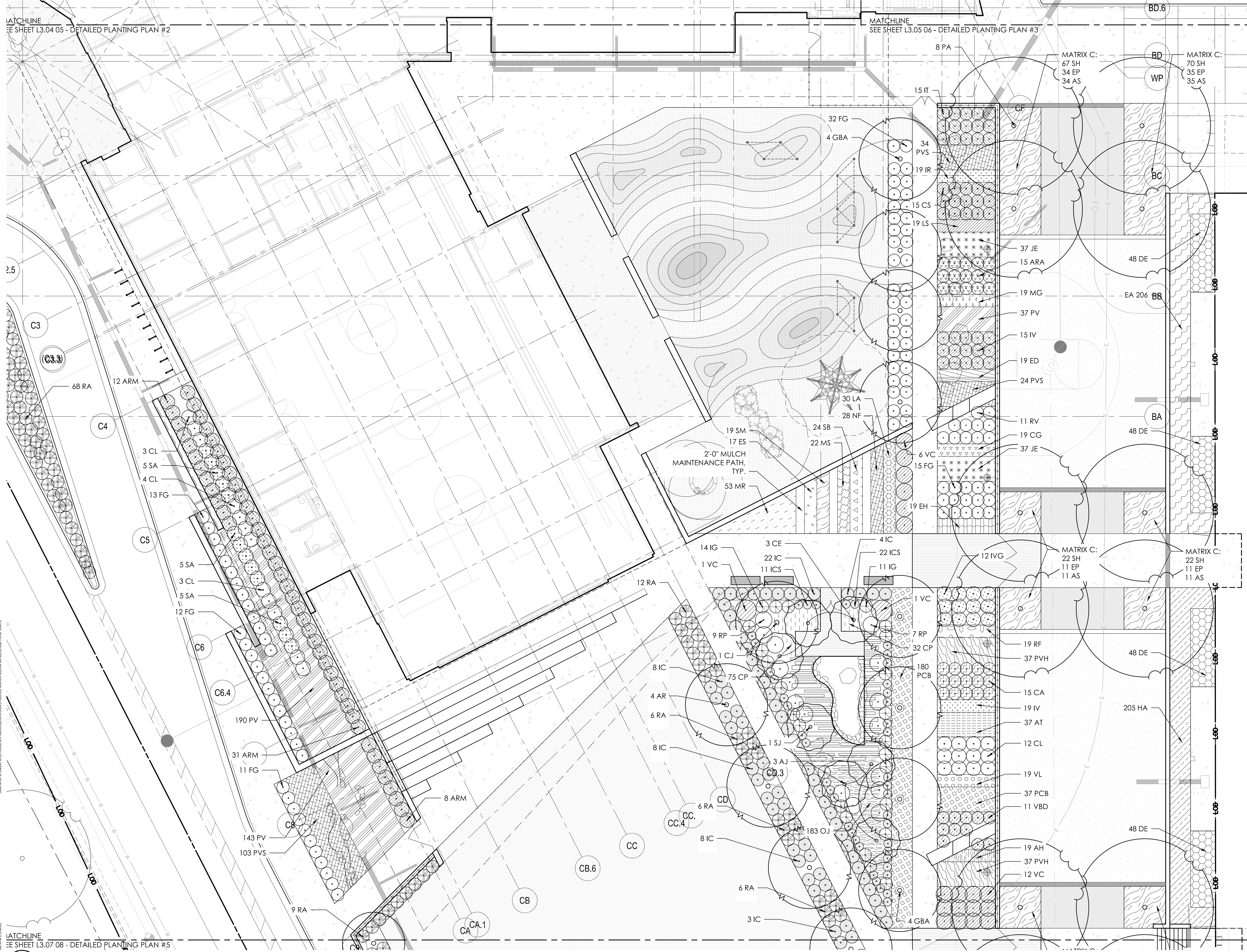



ARLINGTON PUBLIC SCHOOLS

**NEW ELEMENTARY
SCHOOL**

125 South Old Glebe Rd
Arlington, VA 22204

Client Project Number
VMDO Project Number

60FY16
1152

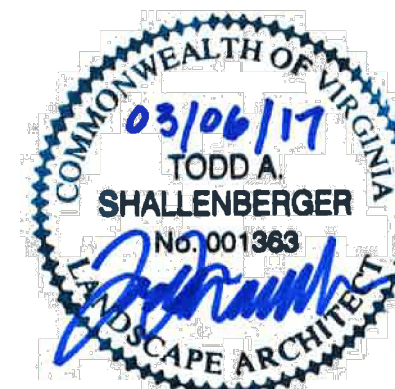

Checked By
Drawn By

T. Shallenberger
P. Price

**DRAWING NOT FOR
CONSTRUCTION**

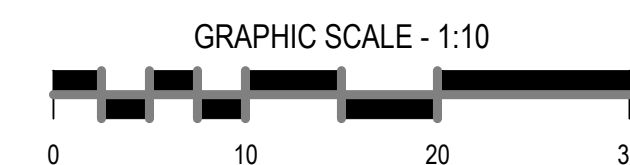

ISSUES AND REVISIONS

| NO. | SUBMITTAL | DATE |
|-----|-------------------------|------------|
| | USE PERMIT RESUBMISSION | 03.06.2017 |

**DETAILED PLANTING PLAN
#5**

L3.07



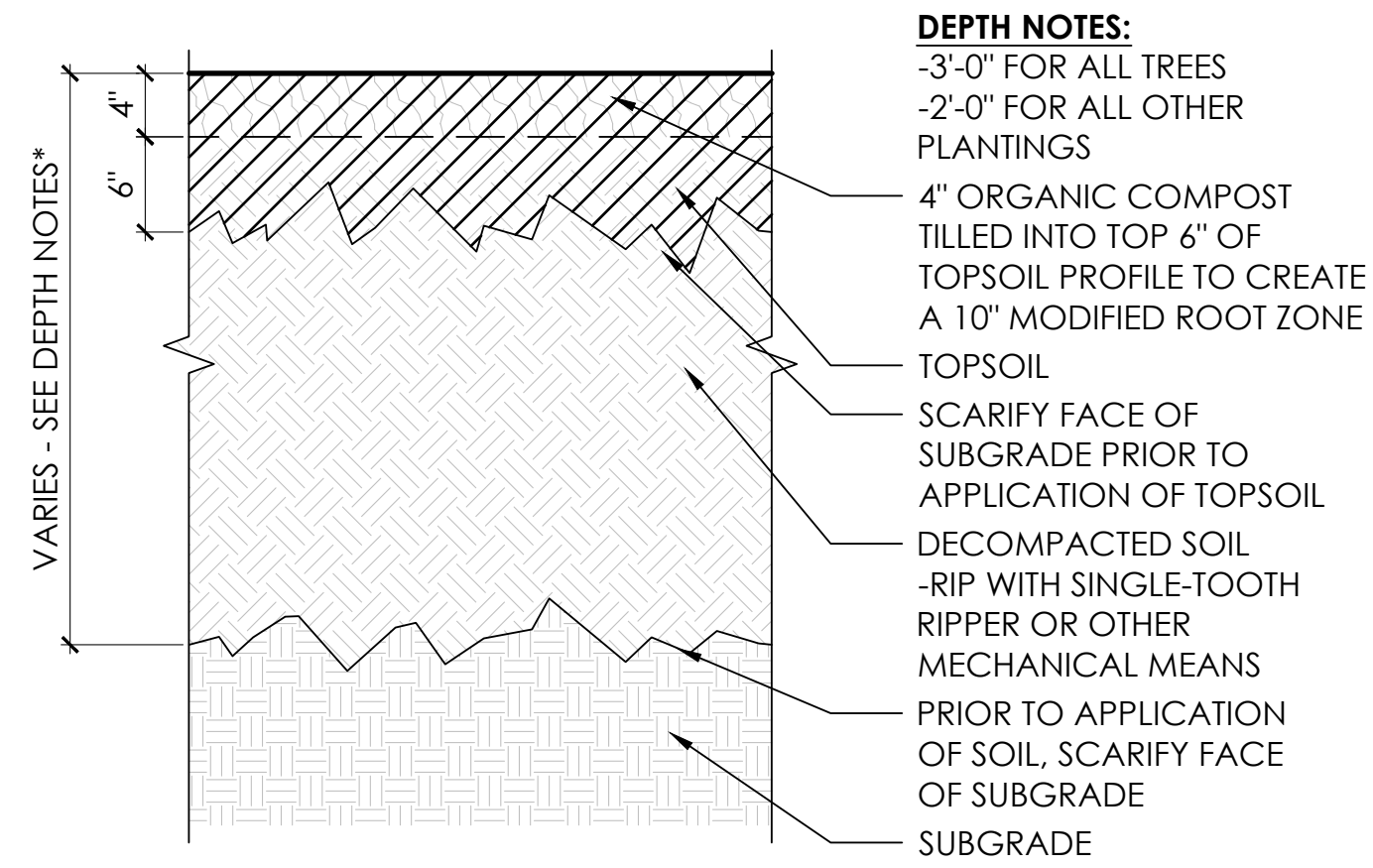

01 PLANTING SOIL - SECTION
SCALE: 1" = 1'-0"

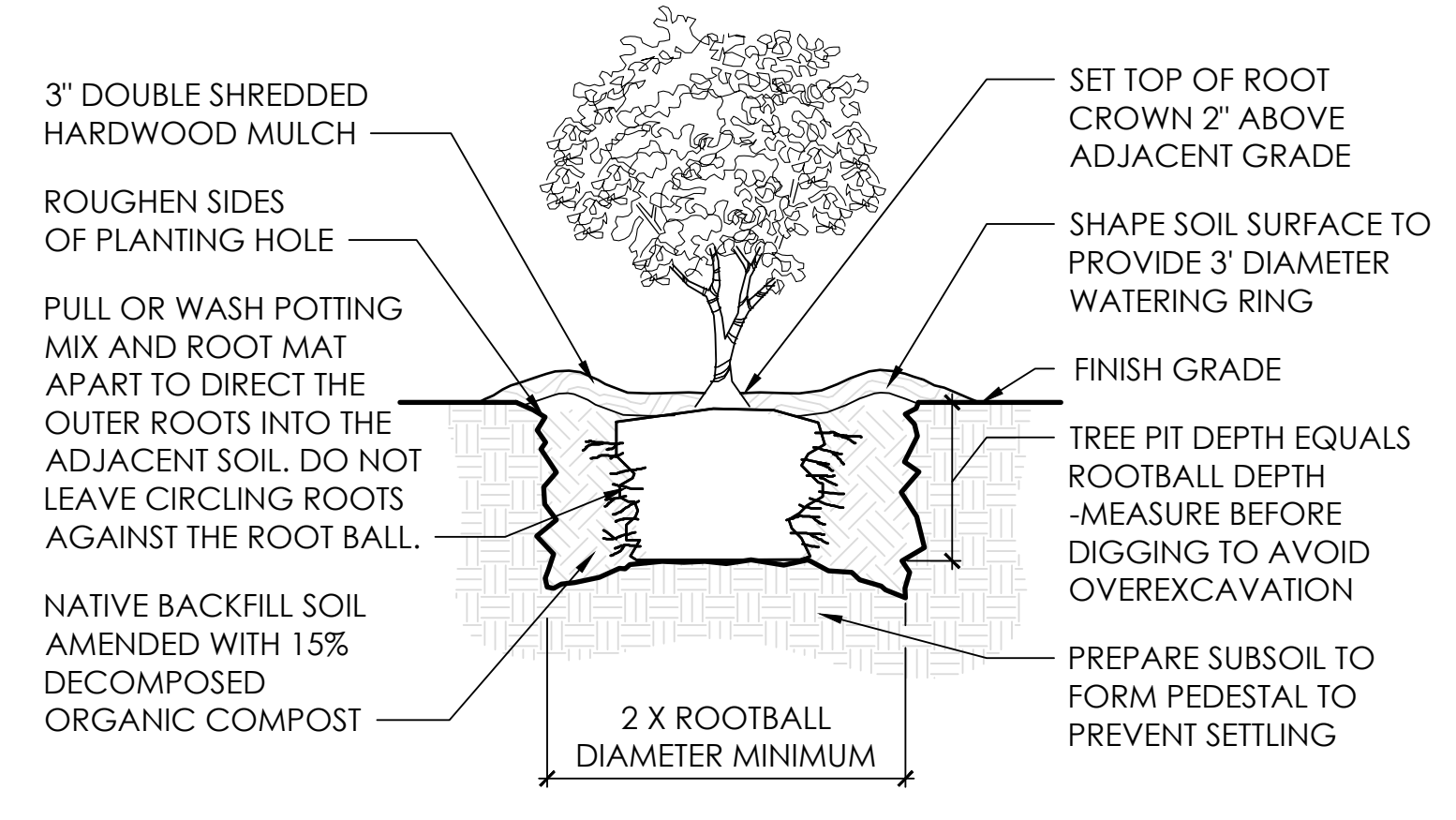

02 SHRUB PLANTING - SECTION
SCALE: 1/2" = 1'-0"

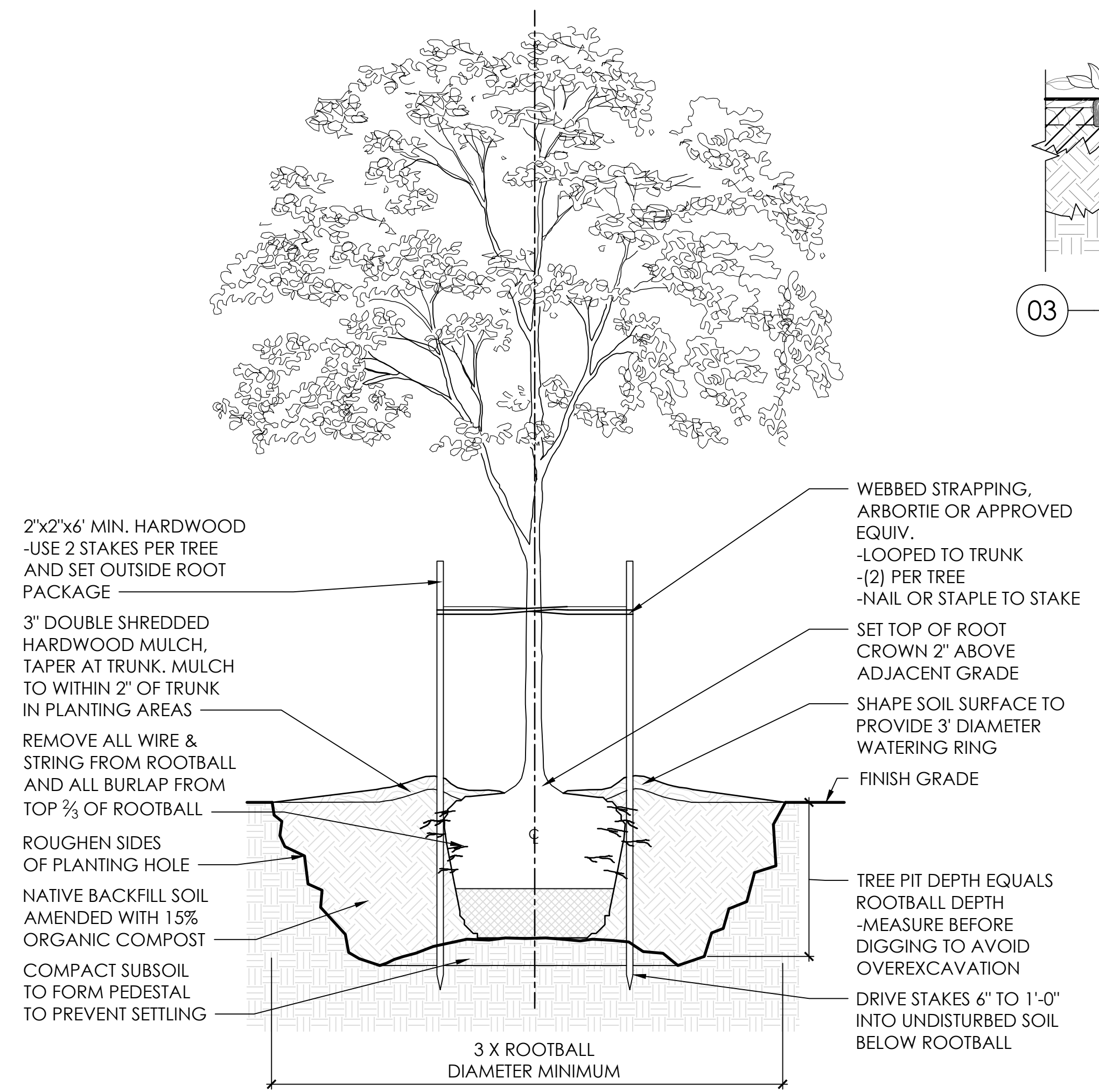

04 TREE PLANTING - SECTION
SCALE: 1/2" = 1'-0"

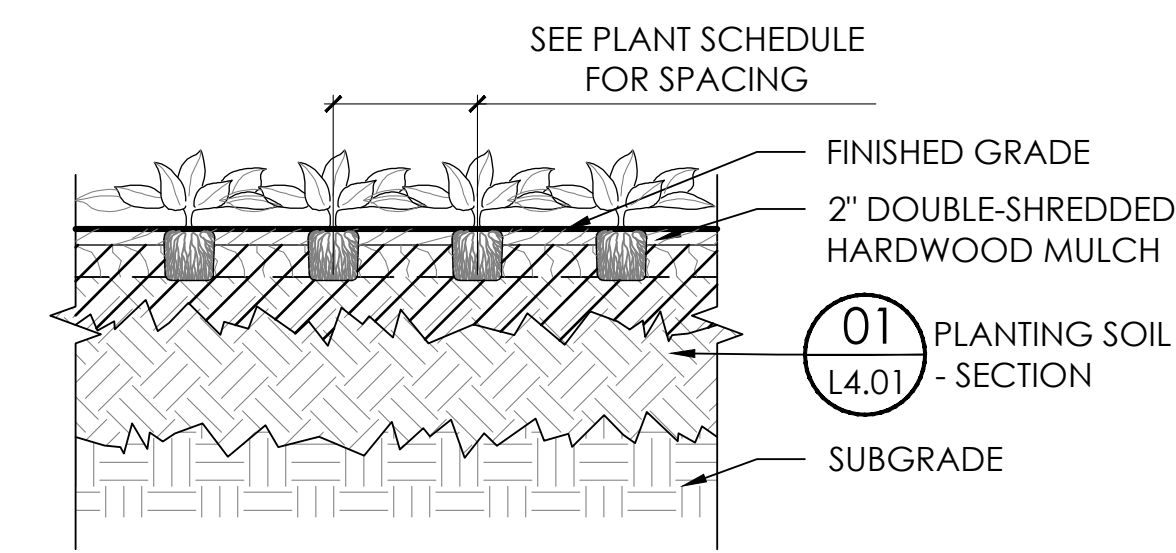

03 PERENNIAL PLANTING - SECTION
SCALE: 1/2" = 1'-0"

CALCULATIONS

14.2.2.B.1 - STREET TREES
REQUIREMENT:
1 TREE PER 35 LINEAR FEET OF PUBLIC RIGHT OF WAY

SITE DATA:
SOUTH OLD GLEBE ROAD
1031 LINEAR FEET

STREET TREES REQUIRED:
29 STREET TREES REQUIRED

STREET TREES PROVIDED:
30 STREET TREES PROVIDED

14.2.2.B.3 - LANDSCAPE AREA
REQUIREMENT:
.25 OF LANDSCAPE AREA COVERED BY SHRUB SPREAD AT MATURITY

SITE DATA:
LANDSCAPE AREA (WITHIN LIMITS OF DISTURBANCE)
53483 SQUARE FEET
23066 S.F. LAWN
13511 S.F. BIORETENTION
16906 S.F. PLANTING BEDS

LANDSCAPE AREA REQUIRED:
13371 SQUARE FEET
LANDSCAPE AREA PROVIDED:
30417 SQUARE FEET

DPR ADMINISTRATIVE REGULATION 4.3 - TREE REPLACEMENT
REQUIREMENT:
REPLACE TREES SLATED FOR REMOVAL (SEE CIVIL SHEET T1.00 & T2.00)

REPLACEMENT TREES REQUIRED:
191 TREE REPLACEMENTS REQUIRED

REPLACEMENT TREES PROVIDED:
263 TREE REPLACEMENTS PROVIDED

| | |
|-----|------------------------|
| 83 | LARGE SHADE TREES |
| 42 | MEDIUM SHADE TREES |
| 102 | MEDIUM EVERGREEN TREES |
| 31 | FLOWERING TREES |
| 5 | UPRIGHT SHADE TREES |

PLANT SCHEDULE

| QTY. | SYMBOL | Scientific Name | Common Name | Size | Spacing | Root | Notes |
|--------------|--------|--|----------------------|-------------|----------|------|-------|
| TREES | | | | | | | |
| 4 | AR | <i>Acer Rubrum</i> 'October Glory' | Red Maple | 2 1/2" Cal. | AS SHOWN | B&B | |
| 5 | AF | <i>Acer x freemanii</i> 'Armstrong' | Armstrong Maple | 3 1/2" Cal. | AS SHOWN | B&B | |
| 3 | AJ | <i>Acer japonicum</i> | Japanese Maple | 7-8' Ht. | AS SHOWN | B&B | |
| 15 | AA | <i>Amelanchier x grandiflora</i> 'Autumn Brilliance' | Servicberry | 7-8' Ht. | AS SHOWN | B&B | |
| 5 | CC | <i>Carpinus caroliniana</i> | Musclewood | 7-8' Ht. | AS SHOWN | B&B | |
| 3 | CE | <i>Cercis canadensis</i> | Red Bud | 7-8' Ht. | AS SHOWN | B&B | |
| 3 | CJ | <i>Cornus Florida</i> 'Appalachian Spring' | Flowering Dogwood | 7-8' Ht. | AS SHOWN | B&B | |
| 1 | CF | <i>Cercidiphyllum japonicum</i> | Katsura Tree | 2' Cal. | AS SHOWN | B&B | |
| 8 | GBA | <i>Ginkgo biloba</i> 'Autumn Gold' | Maidenhair Tree | 2' Cal. | AS SHOWN | B&B | |
| 9 | HM | <i>Hamamelis virginiana</i> | Witchhazel | 7-8' Ht. | AS SHOWN | B&B | |
| 6 | IA | <i>Ilex x attenuata</i> 'Fosteri' | Foster Holly | 6-7' Ht. | AS SHOWN | B&B | |
| 61 | IO | <i>Ilex opaca</i> | American Holly | 6-7' Ht. | AS SHOWN | B&B | |
| 19 | LSC | <i>Liquidambar styraciflua</i> 'Cherokee' | Sweetgum | 3 1/2" Cal. | AS SHOWN | B&B | |
| 6 | LSR | <i>Liquidambar styraciflua</i> 'Rotundiloba' | Sweetgum | 3 1/2" Cal. | AS SHOWN | B&B | |
| 4 | LT | <i>Liriodendron tulipifera</i> | Tulip Tree | 2 1/2" Cal. | AS SHOWN | B&B | |
| 16 | MV | <i>Magnolia virginiana</i> 'Moonglow' | Sweetbay Magnolia | 8-10' Ht. | AS SHOWN | B&B | |
| 16 | NS | <i>Nyssa sylvatica</i> | Black Tupelo | 2' Cal. | AS SHOWN | B&B | |
| 9 | OA | <i>Oxydendrum arboreum</i> | Sourwood | 2' Cal. | AS SHOWN | B&B | |
| 2 | OV | <i>Ostrya virginiana</i> | Eastern Hop Hornbeam | 7-8' Ht. | AS SHOWN | B&B | |
| 18 | PA | <i>Platanus x acerifolia</i> | London Planetree | 3 1/2" Cal. | AS SHOWN | B&B | |
| 1 | QB | <i>Quercus alba</i> | White Oak | 2 1/2" Cal. | AS SHOWN | B&B | |
| 1 | QB | <i>Quercus bicolor</i> | Swamp White Oak | 2 1/2" Cal. | AS SHOWN | B&B | |
| 1 | QC | <i>Quercus coccinea</i> | Scarlet Oak | 2 1/2" Cal. | AS SHOWN | B&B | |
| 1 | QI | <i>Quercus imbricaria</i> | Shingle Oak | 2 1/2" Cal. | AS SHOWN | B&B | |
| 2 | QP | <i>Quercus phellos</i> | Willow Oak | 2 1/2" Cal. | AS SHOWN | B&B | |
| 1 | QM | <i>Quercus michauxii</i> | Swamp Chestnut Oak | 2 1/2" Cal. | AS SHOWN | B&B | |
| 1 | QMT | <i>Quercus montana</i> | Chestnut Oak | 2 1/2" Cal. | AS SHOWN | B&B | |
| 6 | RT | <i>Rhus typhina</i> | Staghorn Sumac | 6-7' Ht. | AS SHOWN | B&B | |
| 1 | SJ | <i>Slyax japonica</i> | Japanese Snowbell | 2' Cal. | AS SHOWN | B&B | |
| 14 | TD | <i>Taxodium distichum</i> | Bald Cypress | 2' Cal. | AS SHOWN | B&B | |
| 21 | TO | <i>Thuja occidentalis</i> 'Nigra' | Arborvitae | 6-7' Ht. | AS SHOWN | B&B | |

SHRUBS

| | | | | | | |
|-----|-----|--|-------------------------|---------|----------|--------|
| 35 | ARA | <i>Aronia arbutifolia</i> | Red Chokeberry | 24" Ht. | 36" O.C. | 3 Gal. |
| 114 | ARM | <i>Aronia melanocarpa</i> | Black Chokeberry | 24" Ht. | 36" O.C. | 3 Gal. |
| 46 | CL | <i>Calliandra americana</i> | Beautyberry | 24" Ht. | 36" O.C. | 3 Gal. |
| 89 | CA | <i>Clethra alnifolia</i> 'Hummingbird' | Summersweet | 24" Ht. | 36" O.C. | 3 Gal. |
| 15 | CS | <i>Cornus sericea</i> 'Arctic Fire' | Red Twig Dogwood | 24" Ht. | 36" O.C. | 3 Gal. |
| 49 | CSF | <i>Cornus sericea</i> 'Flaviramea' | Yellow Twig Dogwood | 24" Ht. | AS SHOWN | 3 Gal. |
| 27 | CSI | <i>Cornus sericea</i> 'Isanti' | Red Twig Dogwood | 24" Ht. | AS SHOWN | 3 Gal. |
| 166 | FG | <i>Fothergilla gardenii</i> | Dwarf Witchhazel | 24" Ht. | 36" O.C. | 3 Gal. |
| 20 | FM | <i>Fothergilla major</i> | Witchhazel | 24" Ht. | 48" O.C. | 3 Gal. |
| 24 | HQ | <i>Hydrangea quercifolia</i> 'Pee Wee' | Oak Leaf Hydrangea | 24" Ht. | 30" O.C. | 3 Gal. |
| 71 | IC | <i>Ilex crenata</i> | Japanese Holly | 24" Ht. | 36" O.C. | 3 Gal. |
| 43 | ICS | <i>Ilex crenata</i> 'Soft Touch' | Japanese Holly | 24" Ht. | 24" O.C. | 3 Gal. |
| 45 | IG | <i>Ilex glabra</i> 'Shamrock' | Inkberry Holly | 24" Ht. | 36" O.C. | 3 Gal. |
| 189 | IT | <i>Ilex virginica</i> 'Henry's Garnet' | Virginia Sweetspire | 24" Ht. | 36" O.C. | 3 Gal. |
| 37 | IV | <i>Ilex verticillata</i> 'Red Sprite' | Dwarf Winterberry Holly | 24" Ht. | 36" O.C. | 3 Gal. |
| 29 | IVW | <i>Ilex verticillata</i> 'Winter Red' | Winterberry Holly | 24" Ht. | AS SHOWN | 3 Gal. |
| 34 | IVG | <i>Ilex verticillata</i> 'Winter Gold' | Winterberry Holly | 24" Ht. | AS SHOWN | 3 Gal. |
| 16 | RP | <i>Rhododendron periclymenoides</i> | Pinxterbloom | 24" Ht. | AS SHOWN | 3 Gal. |
| 11 | RV | <i>Rhododendron viscosum</i> | Swamp Azalea | 24" Ht. | AS SHOWN | 3 Gal. |
| 163 | RA | <i>Rhus aromatica</i> 'Gro Low' | Fragrant Sumac | 24" Ht. | 36" O.C. | 3 Gal. |
| 36 | SA | <i>Symphoricarpos albus</i> | Snowberry | 24" Ht. | 36" O.C. | 3 Gal. |
| 33 | VD | <i>Viburnum dentatum</i> | Arrowwood Viburnum | 24" Ht. | 48" O.C. | 3 Gal. |
| 25 | VDB | <i>Viburnum dentatum</i> 'Blue Muffin' | Arrowwood Viburnum | 24" Ht. | 36" O.C. | 3 Gal. |
| 56 | VC | <i>Vaccinium corymbosum</i> | Highbush Blueberry | 24" Ht. | AS SHOWN | 3 Gal. |

GRASSES, RUSHES & SEDGES

| | | | | | |
|------|-----|---|--------------------|----------|--------|
| 341 | CP | <i>Carex pensylvanica</i> | Pennsylvania Sedge | 12" O.C. | 1 Gal. |
| 17 | ES | <i>Eragrostis spectabilis</i> | Purple Lovegrass | 18" O.C. | 1 Gal. |
| 183 | JE | <i>Juncus effusus</i> | Soft Rush | 18" O.C. | 1 Gal. |
| 192 | MC | <i>Muhlenbergia capillaris</i> | Pink Muhly Grass | 18" O.C. | 1 Gal. |
| 53 | MR | <i>Muhlenbergia reverchonii</i> 'Undaunted' | Ruby Muhly Grass | 18" O.C. | 1 Gal. |
| 180 | OJ | <i>Ophiopogon japonicus</i> | Mondo Grass | 12" O.C. | 1 Gal. |
| 784 | PV | <i>Panicum virgatum</i> | Switchgrass | 18" O.C. | 1 Gal. |
| 509 | PVC | <i>Panicum virgatum</i> 'Cape Breeze' | Switchgrass | 18" O.C. | 1 Gal. |
| 1264 | PVH | <i>Panicum virgatum</i> 'Heavy Metal' | Switchgrass | 18" O.C. | 1 Gal. |
| 649 | PVS | <i>Panicum virgatum</i> 'Shenandoah' | Switchgrass | 18" O.C. | 1 Gal. |
| 451 | SH | <i>Sporobolus heterolepis</i> | Prairie Dropseed | 18" O.C. | 1 Gal. |

GROUNDCOVERS, PERENNIALS AND FERNS

| | | | | | |
|-----|----|--|------------------------|----------|-------|
| 226 | AS | <i>Allium schoenoprasum</i> | Chives | 18" O.C. | 3 QT. |
| 19 | AH | <i>Amsonia hubrichtii</i> | Blue Star | 18" O.C. | 3 QT. |
| 211 | AT | <i>Amsonia tabernaemontana</i> | Blue Star | 18" O.C. | 3 QT. |
| 19 | CG | <i>Chelone glabra</i> | Turtlehead | 18" O.C. | 3 QT. |
| 287 | DE | <i>Dryopteris erythrosora</i> 'Brilliance' | Autumn Fern | 18" O.C. | 3 QT. |
| 19 | ED | <i>Eupatorium dubium</i> 'Little Joe' | Dwarf Joe Pye Weed | 18" O.C. | 3 QT. |
| 206 | EA | <i>Euphorbia amygdaloides</i> var. <i>robbiae</i> | Wood Spurge | 18" O.C. | 3 QT. |
| 19 | EH | <i>Equisetum hyemale</i> | Horsetail | 18" O.C. | 3 QT. |
| 226 | EP | <i>Echinacea purpurea</i> 'Magnus' | Purple Coneflower | 18" O.C. | 3 QT. |
| 42 | EY | <i>Eryngium yuccifolium</i> | Rattlesnake Master | 18" O.C. | 3 QT. |
| 42 | EM | <i>Eupatorium maculatum</i> 'Gateway' | Joe Pye Weed | 18" O.C. | 3 QT. |
| 411 | GM | <i>Geranium macrorrhizum</i> 'Album' | White Bigroot Geranium | 18" O.C. | 3 QT. |
| 317 | HA | <i>Heuchera macrorrhiza</i> 'Autumn Bride' | Coral Bells | 18" O.C. | 3 QT. |
| 145 | IR | <i>Iris versicolor</i> | Blue Flag | 18" O.C. | 3 QT. |
| 30 | LA | <i>Lavandula x intermedia</i> | French Lavender | 18" O.C. | 3 QT. |
| 19 | LS | <i>Lobelia siphilitica</i> | Blue Cardinal Flower | 18" O.C. | 3 QT. |
| 22 | MS | <i>Mentha</i> sp. | Mint | 18" O.C. | 3 QT. |
| 131 | MG | <i>Monarda</i> 'Claire Grace' | Wild Bergamot | 18" O.C. | 3 QT. |
| 53 | NF | <i>Nepeta x laassenii</i> 'Walker's Low' | Catmint | 18" O.C. | 3 QT. |
| 138 | OC | <i>Osmunda cinnamomea</i> | Cinnamon Fern | 18" O.C. | 3 QT. |
| 172 | RF | <i>Rudbeckia fulgida</i> var. <i>sullivantii</i> 'Little Goldstar' | Black Eyed Susan | 18" O.C. | 3 QT. |
| 19 | SM | <i>Sedum</i> 'Matrona' | Stonecrop | 18" O.C. | 3 QT. |
| 24 | SB | <i>Stachys byzantina</i> 'Helene Von Stein' | Lamb's Ear | 18" O.C. | 3 QT. |
| 19 | VL | <i>Vernonia lettermanii</i> 'Iron Butterfly' | Ironweed | 18" O.C. | 3 QT. |



VMDO Architects
200 E. Market Street
Charlottesville, VA 22902
434.296.5684
vmdo.com

waterstreetstudio
landscape architecture | civil engineering
418 E. Main Street 434.295.8177 Charlottesville, VA 22902

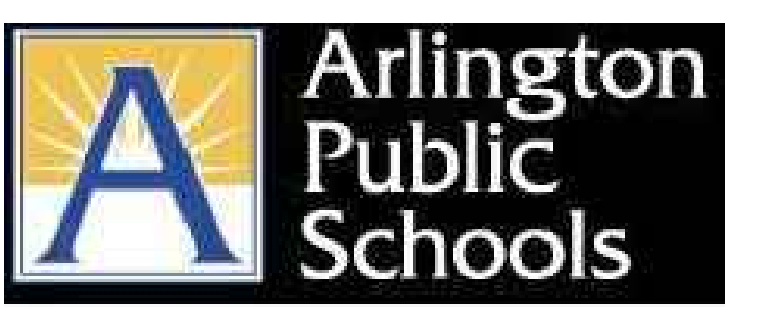

ARLINGTON PUBLIC SCHOOLS

NEW ELEMENTARY SCHOOL

125 South Old Glebe Rd
Arlington, VA 22204

Client Project Number 60FY16
VMDO Project Number 1152

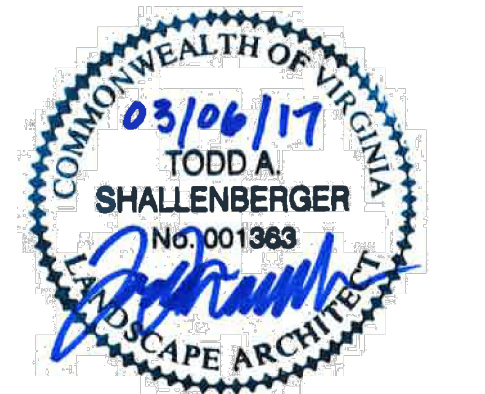

Checked By T. Shallenberger
Drawn By P. Price

DRAWING NOT FOR CONSTRUCTION

ISSUES AND REVISIONS
NO. SUBMITTAL DATE
USE PERMIT SUBMISSION 11.30.2016
USE PERMIT RESUBMISSION 03.06.2017

PLANT SCHEDULE, NOTES, DETAILS, AND CALCULATIONS

L4.01

C:\Users\jshallen\OneDrive\Documents\Projects\New Elementary School\Drawings\Sheet\PLANT SCHEDULE NOTES.DWG DATE: 03/06/2017 11:01:23 AM

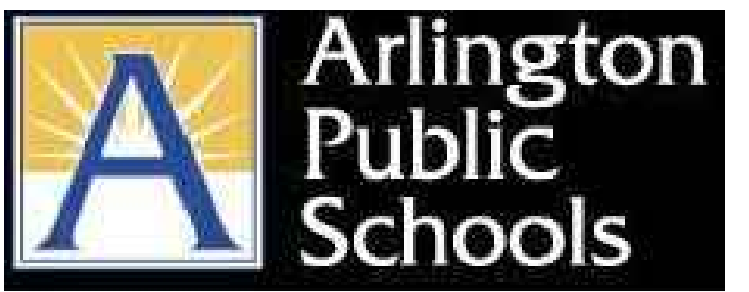

ARLINGTON PUBLIC SCHOOLS

NEW ELEMENTARY SCHOOL

125 South Old Glebe Rd
Arlington, VA 22204

Client Project Number 60FY16
VMDO Project Number 1152

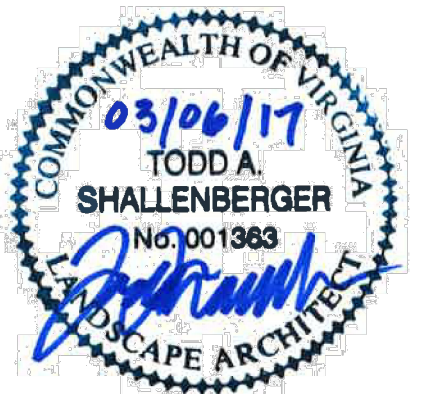

Checked By T. Shallenberger
Drawn By P. Price

DRAWING NOT FOR CONSTRUCTION

| ISSUES AND REVISIONS | |
|----------------------------|------------|
| NO. | DATE |
| 1. SUBMITTAL | 03.06.2017 |
| 2. USE PERMIT RESUBMISSION | |

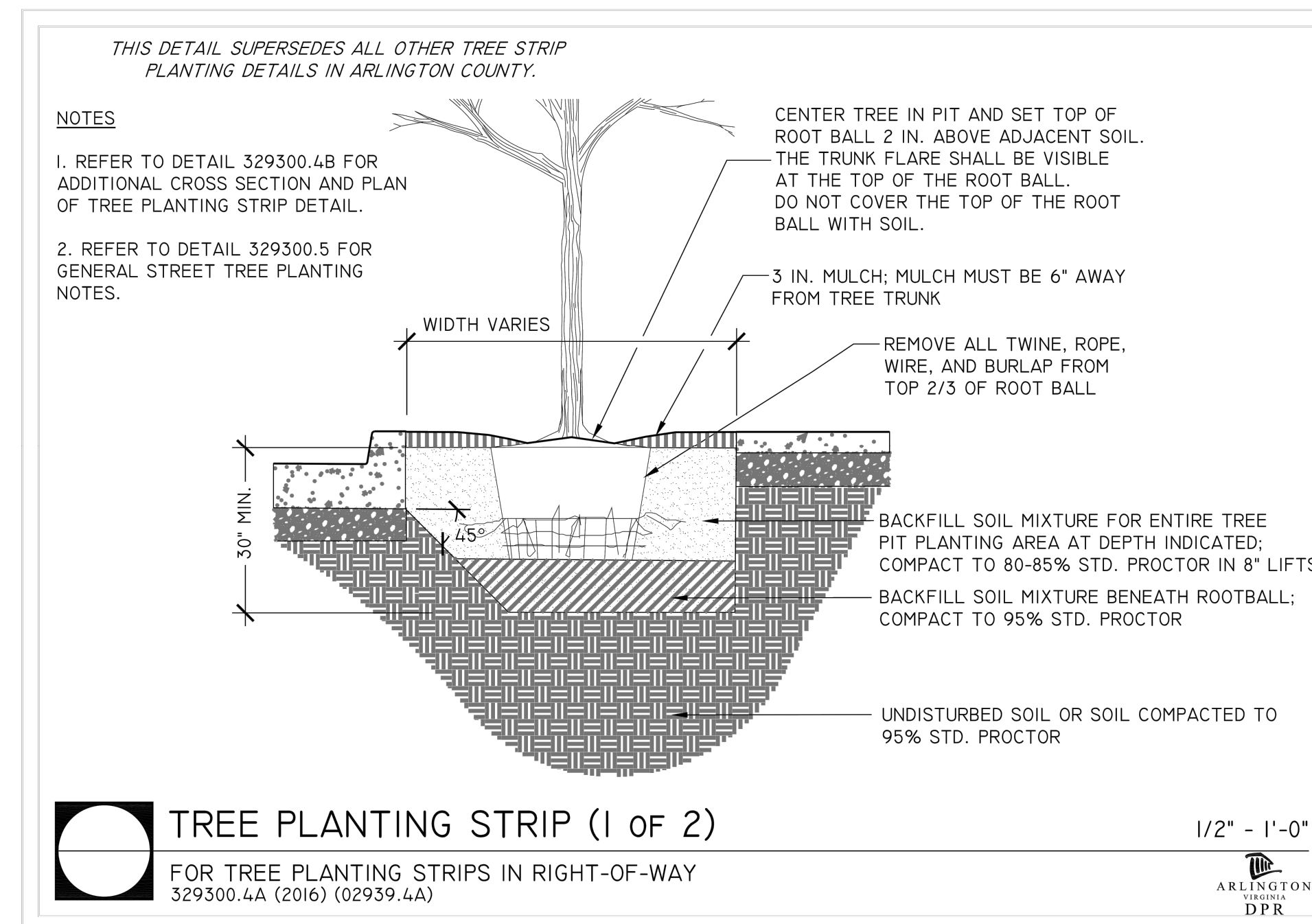

NOTES

- A PERMIT IS REQUIRED WHEN TREES ARE PLANTED IN PUBLIC RIGHT-OF-WAY OR IN A PUBLIC EASEMENT. THE DEPARTMENT OF ENVIRONMENTAL SERVICES SHALL ISSUE THE PERMIT ACCORDING TO THE PROVISIONS OF THE CURRENT ARLINGTON COUNTY ADMINISTRATIVE REGULATION 4.3.
- TREE SPECIES SHALL BE SELECTED FROM THE "ARLINGTON COUNTY STREET TREE LIST" OR PER SECTOR PLAN REQUIREMENTS.
- TREES SHALL BE NURSERY GROWN SPECIMENS THAT MEET THE LATEST EDITION OF THE AMERICAN STANDARDS FOR NURSERY STOCK (ANSI Z60). BALLED AND BURLAPPED TREES SHALL BE SECURELY HELD IN PLACE BY UNTREATED BURLAP AND STOUT ROPE (NYLON ROPE IS NOT ACCEPTABLE). LOOSE, BROKEN OR MANUFACTURED BALLS ARE UNACCEPTABLE.
- CALL MISS UTILITY AT (800) 552-7001 FOR UTILITY LOCATIONS PRIOR TO EXCAVATION.
- AT TIME OF PLANTING PRUNE ONLY CROSSING LIMBS, BROKEN OR DEAD BRANCHES, AND ANY BRANCHES THAT POSE A HAZARD TO PEDESTRIANS. DO NOT PRUNE INTO OLD WOOD ON EVERGREENS.
- TREE PIT AND TREE STRIP PLANTING AREA DIMENSIONS:
(A) 5' X 12' OR LARGER IS STANDARD
(B) 4' X 15' MINIMUM IS ALLOWED PER SITE CONDITIONS AND COUNTY URBAN FORESTER'S APPROVAL.
- SPACE TREES 25'-30' APART OR PER SECTOR PLAN REQUIREMENTS OR SITE CONDITIONS.
- SITE CHARACTERISTICS, SUCH AS OVERHEAD POWER LINES, EXISTING VEGETATION, AND INFRASTRUCTURE ITEMS SUCH AS CURBS, SIDEWALKS AND UTILITIES SHALL BE CONSIDERED. TREES THAT GROW TALLER THAN 25 FEET SHOULD NOT BE PLANTED DIRECTLY UNDER POWER LINES. WHEN POSSIBLE THE TREE LEADER SHALL BE OFFSET FROM POWER LINES.
- BACKFILL SOIL MIXTURE SHALL BE 3/4 EXISTING SOIL, CLEANED OF DEBRIS (GRAVEL, ROCKS, STICKS, TRASH, ETC.) AND MIXED WITH 1/4 ORGANIC MATERIAL (COMPOSTED BARK, LEAF MOLD, OR OTHER PLANT DEBRIS PROCESSED TO A POINT OF DECAY AND APPROVED BY THE COUNTY URBAN FORESTER. PEAT MOSS MAY NOT BE USED.
- IF THE QUANTITY OF ACCEPTABLE EXISTING SOIL IS INSUFFICIENT FOR THE PLANTING REQUIREMENTS, THE CONTRACTOR MAY USE TOPSOIL. SOIL TEST REPORT RESULTS FOR THE TOPSOIL WILL BE MADE AVAILABLE TO THE COUNTY URBAN FORESTER UPON REQUEST. CONTRACTOR SHALL SUBMIT TOPSOIL FOR APPROVAL TO COUNTY URBAN FORESTER THAT MEETS THE FOLLOWING SPECIFICATIONS:
(A.) TOPSOIL CONSISTS OF A SANDY LOAM WITH UNIFORM COMPOSITION AND IS FREE OF STONES, LUMPS, PLANTS, ROOTS, AND OTHER DEBRIS OVER 1/2" IN LENGTH.
(B.) TOPSOIL HAS A PH RANGE OF 5.5 TO 6.5 AND A MINIMUM CONTENT OF 1.0% ORGANIC MATTER
(C.) TOPSOIL DOES NOT CONTAIN TOXIC SUBSTANCES HARMFUL TO PLANT GROWTH. SOLUBLE SALT LEVEL SHALL NOT EXCEED 3 MILLIOHMS PER CENTIMETER.
- TREES PLANTED WITHOUT THE TRUNK FLARE VISIBLE WILL BE REJECTED.
- TREES MAY ONLY BE STAKED IF REQUIRED BY THE COUNTY URBAN FORESTER. REFER TO ARLINGTON COUNTY STANDARD STAKING DETAILS.
- MULCH SHALL BE CLEAN, SCREENED, DOUBLE-HAMMERED HARDWOOD BARK MULCH, UNIFORM IN SIZE AND FREE OF STONES, CLODS, NON-ORGANIC DEBRIS AND OTHER FOREIGN MATERIAL.
- ALL PLANTS SHALL BE WATERED TWICE: ONCE AT INSTALLATION AND AGAIN WITHIN 48-HOURS OF INSTALLATION. EACH WATERING WILL CONSIST OF 20 GALLONS PER TREE.
- CONTRACTOR SHALL LEGALLY REMOVE EXCESS SOIL & DEBRIS FROM SITE.

GENERAL NOTES FOR STREET TREE PLANTINGS

FOR TREES PLANTED IN RIGHT-OF-WAY
329300.5 (2016) (02930.5)

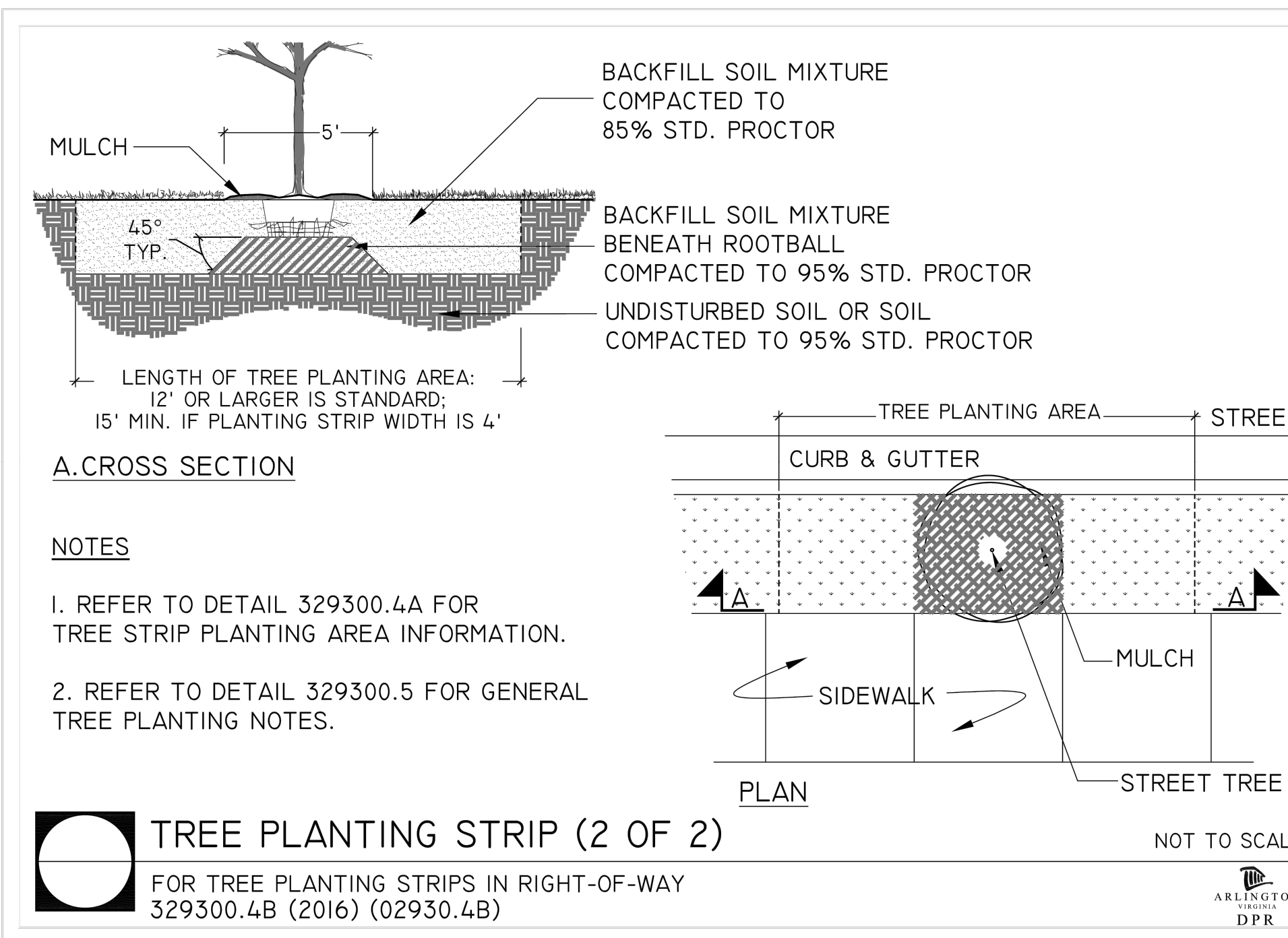

NOTES

- REFER TO DETAIL 329300.4A FOR TREE STRIP PLANTING AREA INFORMATION.
- REFER TO DETAIL 329300.5 FOR GENERAL TREE PLANTING NOTES.

PLANTING NOTES

- CONTRACTOR SHALL VERIFY PLANT QUANTITIES SHOWN ON PLAN WITH TOTALS IN PLANTING SCHEDULE. NOTIFY LANDSCAPE ARCHITECT OF ANY DISCREPANCIES PRIOR TO FINAL BIDDING. UNITS PRICES BE SUBMITTED AS PART OF FINAL BID.
- ALL PLANTS SHALL BE GUARANTEED FOR ONE (1) FULL YEAR AND SHALL BE IN A HEALTHY GROWING CONDITION. PLANT MATERIALS WHICH DO NOT FULFILL THIS GUARANTY SHALL BE REPLACED AT NO COST TO THE OWNER. REPLACEMENT SHALL BE GUARANTEED THROUGHOUT THE ORIGINAL GUARANTY PERIOD. PLANTS THAT DIE SHALL BE REPLACED IMMEDIATELY.
- CONTRACTOR IS RESPONSIBLE FOR WATERING, WEEDING, PEST CONTROL, AND FERTILIZATION OF ALL PLANTS UNTIL, a.) UPON FINAL ACCEPTANCE IS ISSUED BY LANDSCAPE ARCHITECT AND/OR OWNER, AND b.) THE CONTRACTOR PROVIDES OWNER WRITTEN NOTIFICATION OF ALL MAINTENANCE NEEDS OF ALL SCOPE ASSOCIATED WITH THE PLANTING PLAN(S) CONTRACT DOCUMENTS.
- CONTRACTOR IS RESPONSIBLE FOR CONTACTING MISS UTILITY PRIOR TO THE BEGINNING OF CONSTRUCTION FOR LOCATION OF ALL UTILITY LINES. TREES SHALL BE LOCATED A MINIMUM OF FIVE (5) FEET FROM SEWER/WATER CONNECTIONS. NOTIFY LANDSCAPE ARCHITECT OF CONFLICTS.
- THE LANDSCAPE ARCHITECT IS THE OWNER'S REPRESENTATIVE AND SHALL BE THE APPROVING AUTHORITY FOR INFORMATION PROVIDED WITHIN THESE PLANS AND SPECIFICATIONS.
- ALL PLANTS, TOPSOIL, MULCH, FERTILIZERS, SOIL AMENDMENTS, PLANTING SUPPLIES, AND METHODS SHALL BE SUBJECT TO LANDSCAPE ARCHITECTS APPROVAL. REJECTED MATERIALS SHALL BE REMOVED FROM THE SITE WITHOUT DELAY AT NO EXPENSE TO THE OWNER.
- CONTRACTOR SHALL LAYOUT AND MARK LOCATION FOR ALL PLANTS, AND IMPROVEMENTS SHOWN AND SHALL REQUEST IN FIELD APPROVAL FROM LANDSCAPE ARCHITECT.
- ALL PLANTS AND PLANTING METHODS SHALL CONFORM TO A.A.N. STANDARDS.
- BEDS TO CONTAIN SHRUBS, PERENNIALS, ORNAMENTAL GRASSES, OR PERENNIALS SHALL BE TILLED TO A DEPTH OF 12" AND THE SOIL CONDITIONED BY ADDING 3" OF A U.S. COMPOSTING COUNCIL APPROVED COMPOST.
- ALL PLANTING BED AREAS SHALL BE COVERED WITH A 3" MINIMUM LAYER OF MEDIUM TEXTURED SHREDDED HARDWOOD MULCH UNLESS OTHERWISE NOTED.
- ALL SUBSTITUTIONS OF PLANTS SHALL BE REQUESTED IN WRITING TO THE LANDSCAPE ARCHITECT AND APPROVED IN WRITING BY THE OWNER OR THE OWNER'S REPRESENTATIVE.
- ALL PLANTING OPERATIONS SHALL BE UNDER THE SUPERVISION OF AN EXPERIENCED PLANTSMAN.
- LANDSCAPE ARCHITECT RESERVES THE RIGHT TO SELECT PLANTS IN THE NURSERY.
- FOR TREES BALLED IN WIRE BASKETS, CUT AND REMOVE TOP AND SIDES OF BASKET AFTER INSTALLATION.
- LANDSCAPE ARCHITECT RESERVES THE RIGHT TO REJECT AND PLANTS AND MATERIALS THAT ARE IN AN UNHEALTHY OR UNSIGHTLY CONDITION, AS WELL AS PLANTS AND MATERIALS THAT DO NOT CONFORM TO A.A.N. STANDARDS.
- SOIL SHALL BE FREE OF ALL WEEDS AND ROCKS GREATER THAN 1" IN DIAMETER.
- PLANT SIZES, QUANTITIES, AND SPECIES WILL BE CHECKED BY MUNICIPALITY INSPECTION FOR COMPLIANCE WITH PLANT SCHEDULE AS APPROVED BY THE MUNICIPALITY. CONTRACTOR SHALL BE HELD RESPONSIBLE FOR DELAY IN ISSUANCE OF CERTIFICATE OF OCCUPANCY BY THE MUNICIPALITY RESULTING FROM UNAUTHORIZED SUBSTITUTIONS OR DOWNSIZING.
- UPON COMPLETION OF LANDSCAPE INSTALLATION, THE LANDSCAPE CONTRACTOR SHALL NOTIFY THE GENERAL CONTRACTOR WHO WILL VERIFY COMPLETENESS, INCLUDING THE REPLACEMENT OF ALL DEAD PLANT MATERIAL, AND SCHEDULE A FINAL INSPECTION FOR ACCEPTANCE BY OWNER.
- CONTRACTOR SHALL REMOVE TREE STAKING AT THE END OF THE ONE YEAR WARRANTY PERIOD.

ARLINGTON COUNTY PLANTING DETAILS & NOTES

L4.02

DATE PLOTTED: 03/06/2017 10:00:00 AM

PLOT 1 OF 1